

Wabo® SeismicFloor
Model(s) FNB-200C - 2400C
Horizontal Expansion Control Systems

Installation Procedure

The following installation procedure is very important and must be fully understood prior to beginning any work. To ensure proper installation and performance of expansion joint system the following actions must be completed by the installing contractor. Failure to do so will affect product warranty.

- 1) Carefully read and understand installation procedure. Contact Sika Emseal's Technical Service Department at 508-836-0280 for product assistance.
- 2) Inspect all shipments and materials for missing or damaged components and hardware upon arrival. Contact Customer Service at 508-836-0280 with Emseal's order number and invoice for prompt assistance.
- 3) Inspect substrate or adjacent construction for acceptance before beginning work. Report unacceptable construction to the project manager for scheduled repair work.
- 4) Review Emseal shop drawings for project specific detailed information if Engineering services were provided at time of order.

Standard components

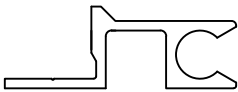

FNB Aluminum Base Extrusion
(Models: 200 thru 400)
P/N: 11112B

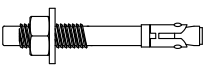

1/4" x 2-1/2" Concrete
Anchor w/ Nut and Washer
P/N: 6587

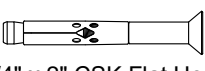

1/4" x 2" CSK Flat Head
Concrete Anchor
P/N: 6913
(Corner Condition)



Aluminum Base Assembly
(Models: 600 thru 2400)
P/N: 15804

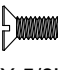

1/4" X 5/8" Screw
P/N: 5620



1/4" X 1 1/4" Screw
P/N: 5621

Components shown below vary in size depending on model of system

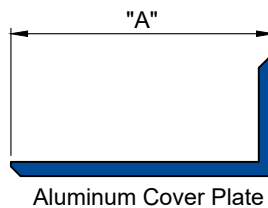

Model	"A"	Part Number	Model	"A"	Part Number
FNB-200C	3 7/16"	12160	FNB-1000C	13 15/16"	12166
FNB-400C	5 7/16"	12162	FNB-1200C	15 13/16"	12167
FNB-600C	8 3/8"	12164	FNB-1800C	23 1/2"	12168
FNB-800C	11 1/8"	12165	FNB-2400C	30"	12169

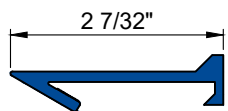

FNB-600C
Aluminum Flange
Extension
P/N: 11015

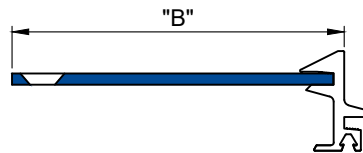

Model	"B"	Part Number	Model	"B"	Part Number
FNB-1000C	3 1/4"	12040	FNB-1800C	5 7/16"	12170
FNB-1200C	3 3/4"	12041	FNB-2400C	5 15/16"	12171

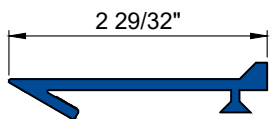

FNB-800C Aluminum
Flange Extension
P/N: 11091

See Sheet 4 for Aluminum
Flange Extension Design
Configurations



BUILDING TRUST



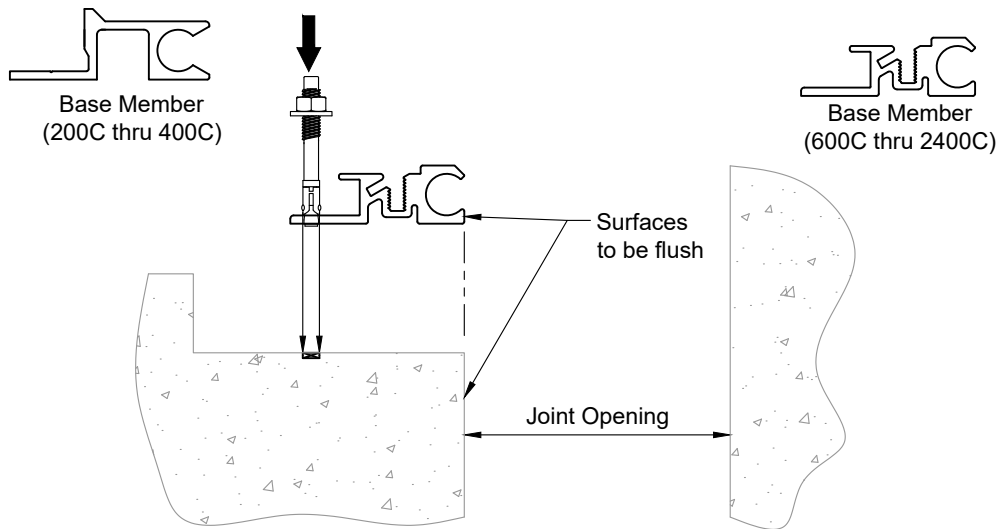

Position base member on block out so cavity of base member is flush with edge of opening.

Using Base Member as a template and with its position fixed, drill hole for 1/4" x 2-1/2" Concrete Anchor (P/N 6587) to proper depth. Clean out holes.

Notes: Follow Hilti's recommendations for proper Anchor installation.

Caution: Do not install all Base Members prior to reviewing step 4.

1

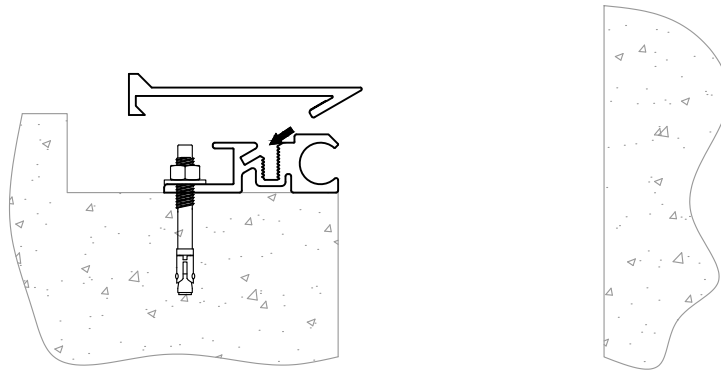

2A

FNB-600C thru FNB-800C

Attach Aluminum Flange Extension to Base Member. Aluminum Flange Extension type depends on system size. Check page 1 for proper Extension size.

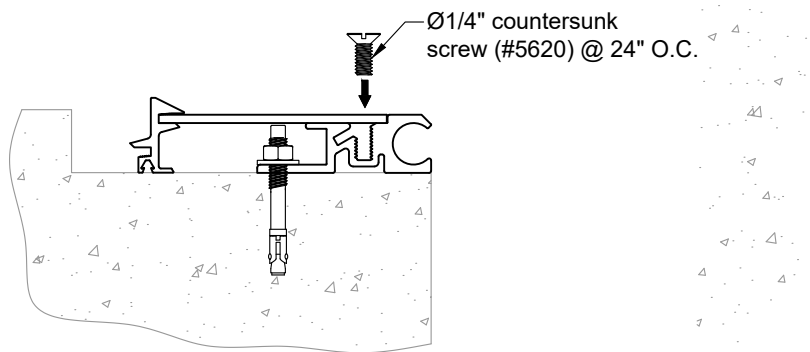

2B

FNB-1000C thru FNB-2400C

Attach aluminum flange extensions to base member. Utilizing the 1/4" Dia x 5/8" screw, fasten extension wing to the top of the Aluminum Base Member at the pre-drilled locations in the extension wing.

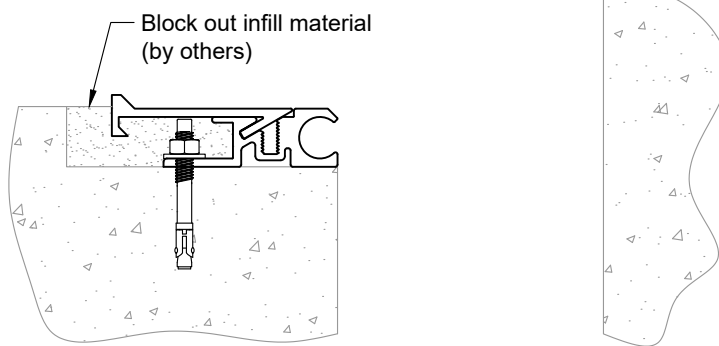

3

Fill block out with high quality non-shrink material. Protect surfaces during placement of filler material.

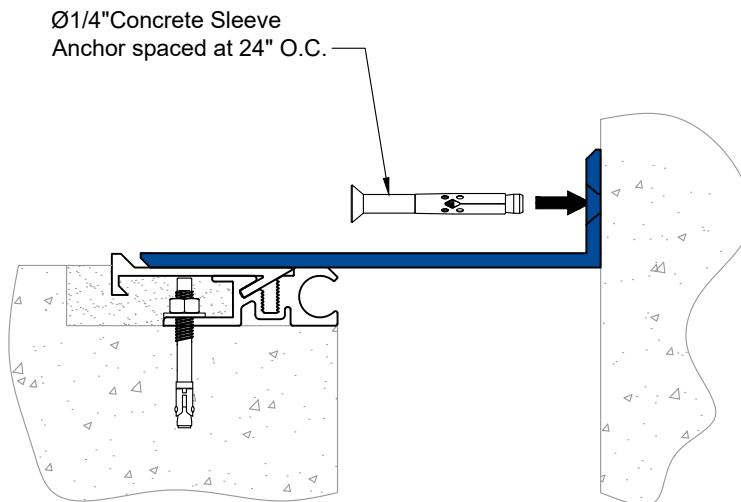

4

Position Corner Cover Plate into the assembly and use the Cover Plate as a template. With its position fixed, drill hole for 1/4" Diameter Concrete Anchor to proper depth. Clean out holes.

Notes: Follow Hilti's recommendations for proper Anchor installation.

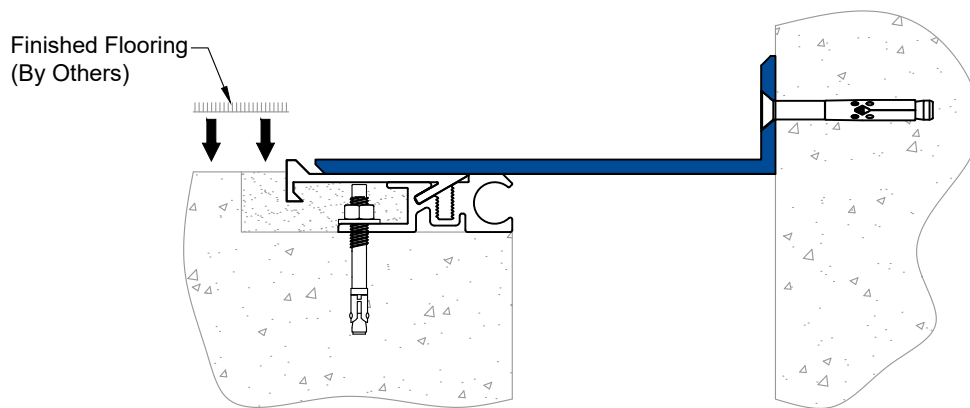

5

Install flooring material. Ensure flush installation with top of expansion joint system.

Caution: Contact flooring manufacturer to discuss application and procedure for proper installation.

Aluminum Flange Extension Design

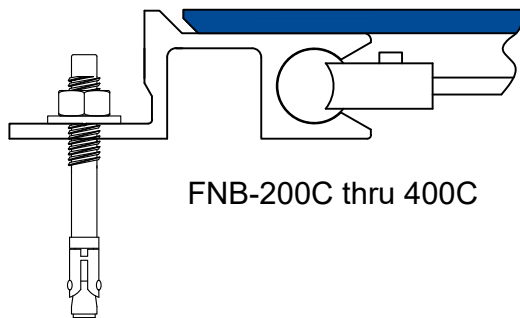

FNB-200C thru 400C

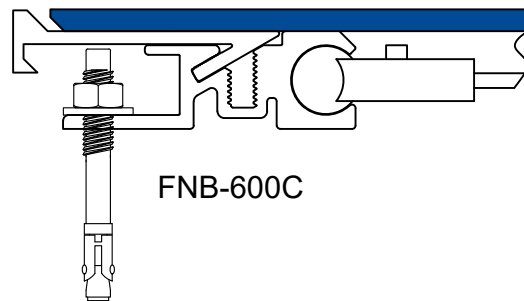

FNB-600C

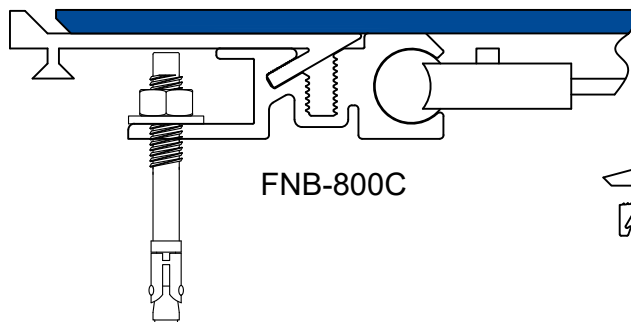

FNB-800C

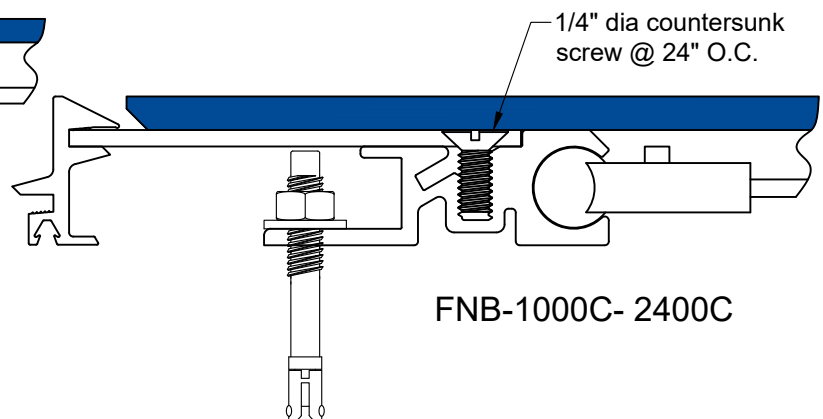

FNB-1000C- 2400C



BUILDING TRUST



Information provided herein, including but not limited to, any drawing, design, photograph, graphic, or statement(s) ("Materials") are proprietary and the property of Sika Emseal. ("Company"). Reproduction, translation, or reduction to any electronic medium or machine readable form, in whole or part, is strictly prohibited, except for the express purpose for which it has been furnished, without prior written consent of Company. All Materials contained herein are provided by Company for information purposes only. Company reserves the right to amend or withdraw any information contained in the Materials without notice. All technical or other advice by Company, whether verbal or written, concerning products, or the use of products in specific situations ("Advice") is given by Company and is used at the User's own risk.

Sika Emseal
25 Bridle Lane, Westborough, MA 01581 USA
Phone: 508-836-0280 / Fax 508-836-0281
www.emseal.com

Rev. 1.0 07-21-2025



BUILDING TRUST

