

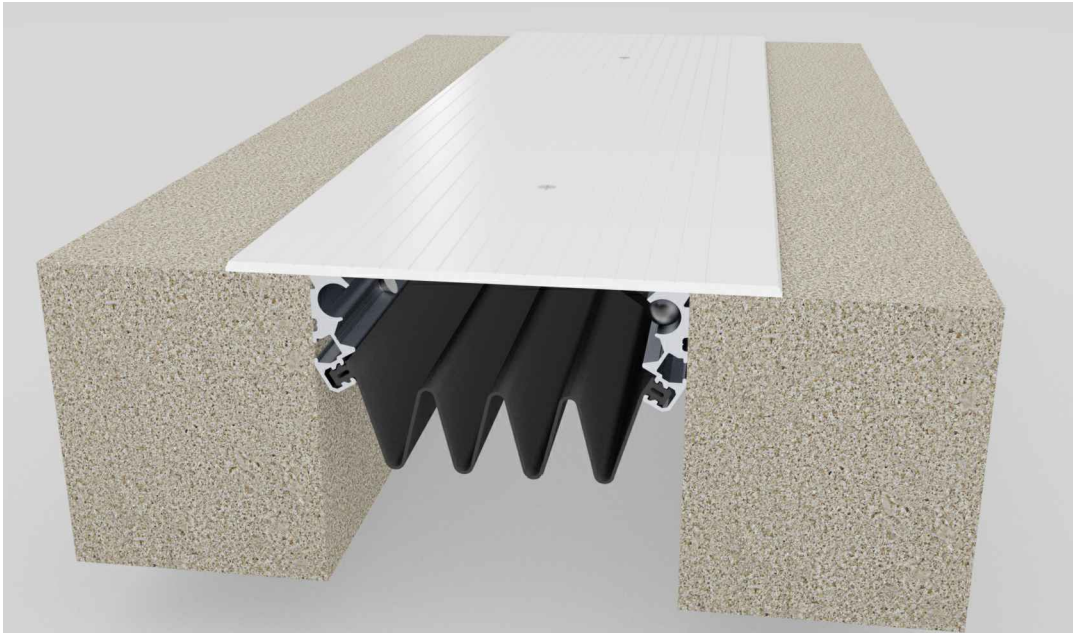

BUILDING TRUST



Installation Procedure

Wabo® SeismicFloor Model(s) FXE400 - 1800 Horizontal Expansion Control Systems

The following installation procedure is very important and must be fully understood prior to beginning any work. To ensure proper installation and performance of expansion joint system the following actions must be completed by the installing contractor. **Failure to do so will affect product warranty.**

- 1) Carefully read and understand installation procedure. Contact Sika Emseal's Technical Service Department at 508-836-0280 for product assistance.
- 2) Inspect all shipments and materials for missing or damaged components and hardware upon arrival. Contact Customer Service at 508-836-0280 with Emseal's order number and invoice for prompt assistance.
- 3) Inspect substrate or adjacent construction for acceptance before beginning work. Report unacceptable construction to the project manager for scheduled repair work.
- 4) Review Emseal shop drawings for project specific detailed information if Engineering services were provided at time of order.

Standard Components



Aluminum Extrusion
Base Member
P/N: 15398

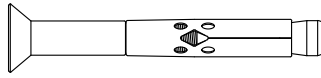

1/4" x 2 1/4" Concrete
Anchor
P/N: 6913



1/4" X 1 1/4" Lg Screw
P/N: 5621

Components shown below vary in size depending on model of system

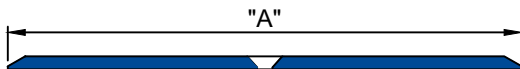

Aluminum Cover Plate

Model	"A"	Part Number
FXE400	6 1/2"	12032B
FXE600	9 1/2"	12033B
FXE800	12 1/2"	12025
FXE1000	15 1/2"	12026
FXE1200	18 1/2"	12027
FXE1800	27 1/2"	12028

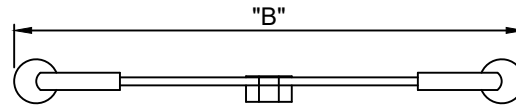

Self-Centering Bar

Model	"B"	Part Number
FXE400	7 3/8"	15642
FXE600	12 3/8"	15643
FXE800	18 3/8"	15630
FXE1000	18 3/8"	15630
FXE1200	22 3/8"	15631
FXE1800	32 3/8"	15644



Moisture Barrier
(refer to chart for size and P/n)

Model	Part Number
FXE400	1175
FXE600	1175
FXE800	1175
FXE1000	1176
FXE1200	1176
FXE1800	1177



BUILDING TRUST



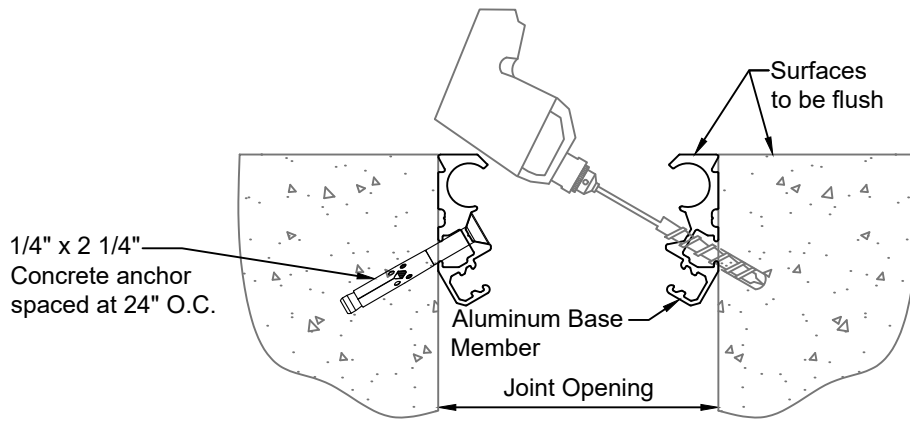

1

Position Base Member so that the top is Flush with the top of the Concrete Surface. Using Base Member as a template and with its position fixed, drill holes for 1/4" x 2 1/4" Concrete Anchor (P/N:6913) spaced at 24" O.C. to the proper depth. Clean out holes and install anchor.

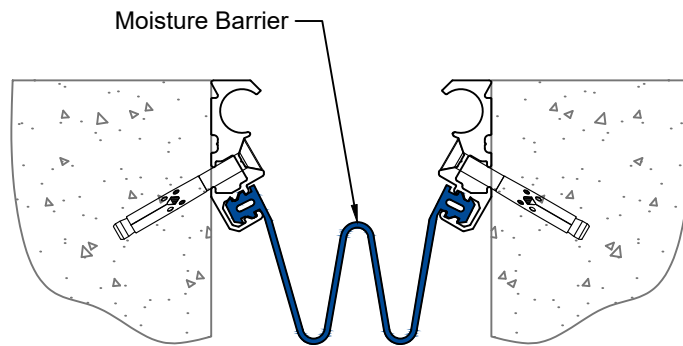

2

Install Moisture Barrier using a soap & water mixture if needed.

Seismic Centering Bar
Spaced at 18" O.C.

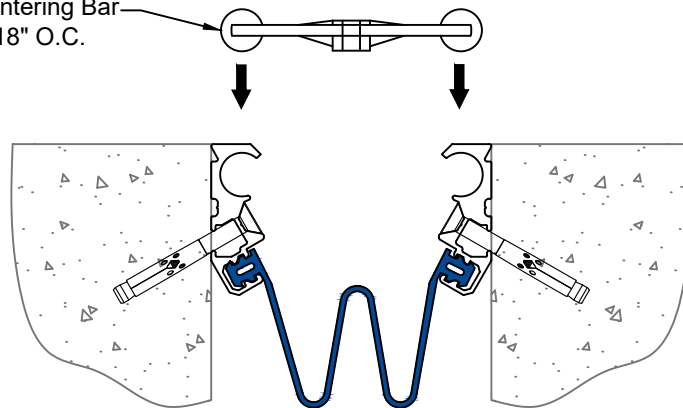

3

As work progresses with placement of Base Members, install Self-Centering Bars by sliding the spherical ends of the bars into the ends of the base members through the circular cavities. Set at an approximate spacing of 18" O.C.
IMPORTANT: Ensure that the "top" indicator is facing up and that all bars are in same orientation.

Finished Flooring Material
(By Others)

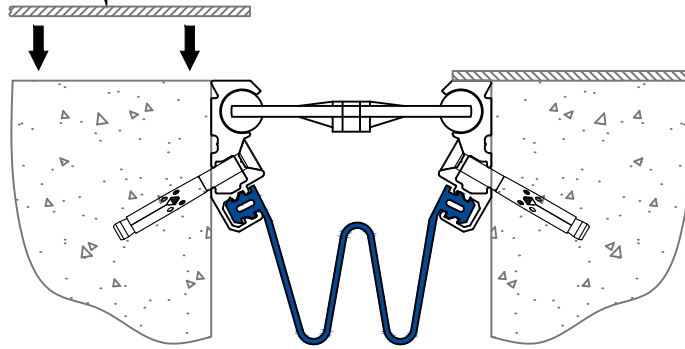

4

Install Finished Flooring material. Ensure flush installation with top of expansion joint system.
Caution - Contact flooring manufacturer to discuss application and procedure for proper installation.

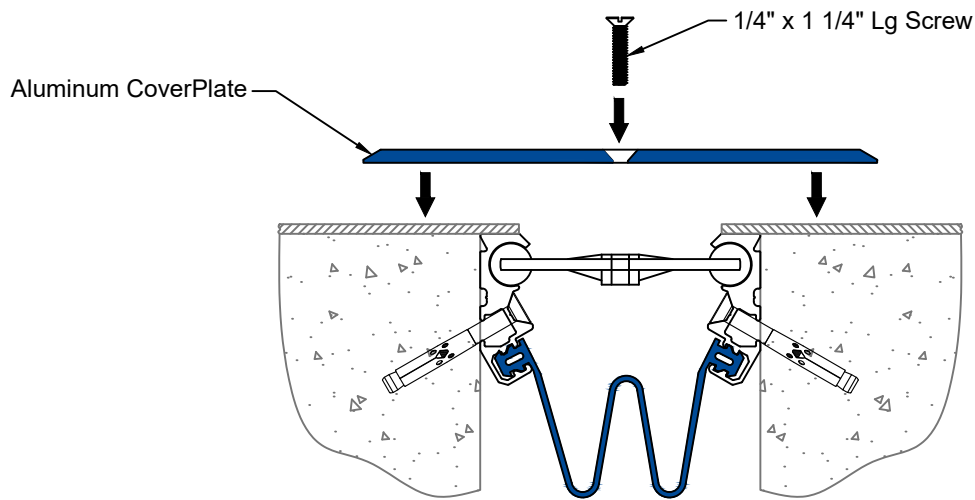

5

Position the aluminum coverplate over expansion opening, align pre-drilled holes in coverplate with threaded insert in self-centering bars. Fasten with 1/4" x 1 1/4" lg screw (P/N 5621). Tighten to create measurable tension in the bar.

LIMITED WARRANTY:

Emseal Joint Systems, Ltd. warrants that this product conforms to its current applicable specifications. Sika EMSEAL MAKES NO OTHER WARRANTY, EXPRESS OR IMPLIED, INCLUDING ANY WARRANTY OF MERCHANTABILITY OR WARRANTY OF FITNESS FOR A PARTICULAR PURPOSE. The sole and exclusive remedy of Purchaser for any claim concerning this product, including, but not limited to, claims alleging breach of warranty, negligence, strict liability or otherwise, is the replacement of product or refund of the purchase price, at the sole option of Emseal. Any claims concerning this product shall be submitted in writing within one year of the delivery date of this product to Purchaser and any claims not presented within that period are waived by Purchaser. IN NO EVENT SHALL Sika EMSEAL BE LIABLE FOR ANY SPECIAL, INCIDENTAL, CONSEQUENTIAL (INCLUDES LOSS OF PROFITS) OR PUNITIVE DAMAGES. Other warranties may be available when the product is installed by a factory trained installer. Contact your local Sika Emseal representative for details. The data expressed herein is true and accurate to the best of our knowledge at the time published; it is, however, subject to change without notice.

Sika Emseal
25 Bridle Lane, Westborough, MA 01581 USA
Phone: 508-836-0280 / Fax 508-836-0281
www.emseal.com

Rev. 1.1 12-11-2024



BUILDING TRUST

