

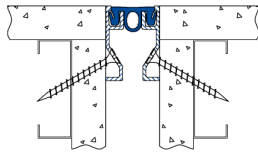

BUILDING TRUST



Installation Procedure



Model CWWF (Flush)

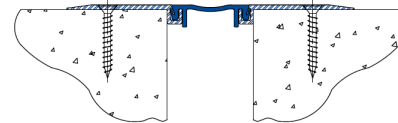
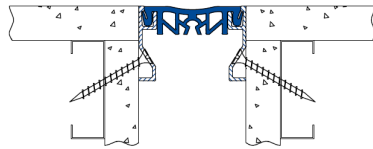

Model CWWM (Surface Masonry)

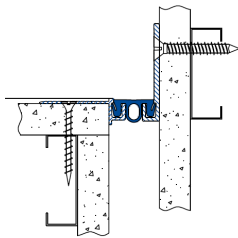
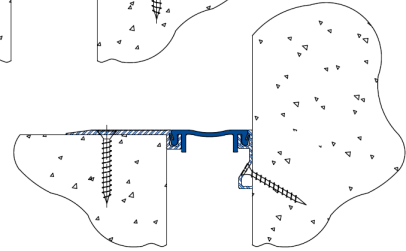

Model CWWE (End/Exposed)

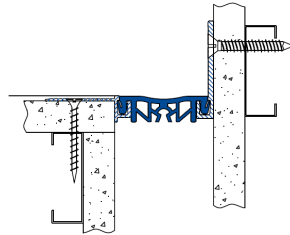

Model CWWS (Surface Drywall)

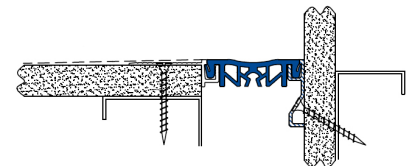

Wabo®CorridorWrap Wall

Vertical Expansion Joint System

The following installation procedure is very important and must be fully understood prior to beginning any work. To ensure proper installation and performance of expansion joint system the following actions must be completed by the installing contractor. Failure to do so will affect product warranty.

- 1) Carefully read and understand installation procedure. Contact Sika Emseal's Technical Service Department at 508-836-0280 for product assistance.
- 2) Inspect all shipments and materials for missing or damaged components and hardware. Contact Customer Service at 508-836-0280 with Emseal's order number and invoice for prompt assistance.
- 3) Inspect substrate or adjacent construction for acceptance before beginning work. Report unacceptable construction to the project manager for scheduled repair work.
- 4) Review Emseal shop drawings for project specific detailed information if Engineering services were purchased at time of order.

Health & Safety

During the installation of any Sika Emseal product, appropriate personal protective items should be worn at all times, including but not limited to the following:

- Proper work clothing
- Safety glasses
- Safety boots
- Gloves
- Hard hat



Local rules and regulations regarding safe work environments and health should be followed.



BUILDING TRUST



Installation Procedure

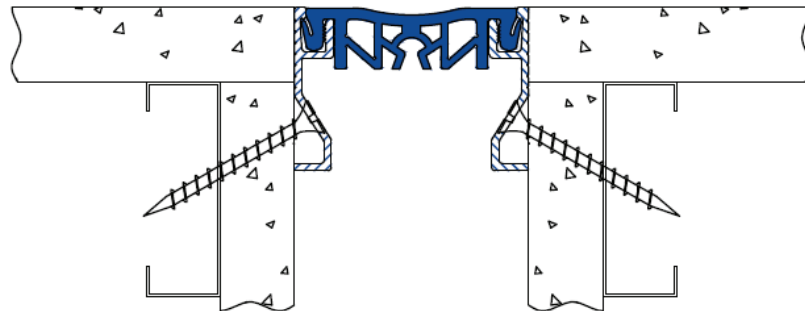
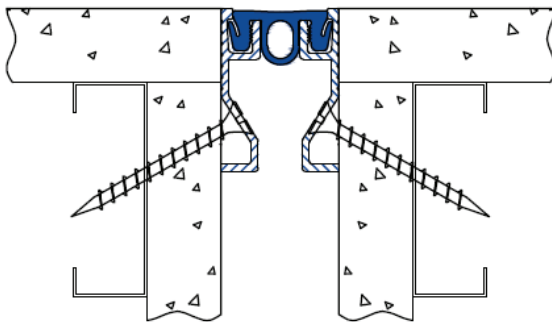

Wabo®CorridorWrap, “CWWF” & “CWWF-C”

Vertical Expansion Joint System

The following installation procedure is very important and must be fully understood prior to beginning any work. To ensure proper installation and performance of expansion joint system the following actions must be completed by the installing contractor. Failure to do so will affect product warranty.

- 1) Carefully read and understand installation procedure. Contact Sika Emseal's Technical Service Department at 508-836-0280 for product assistance.
- 2) Inspect all shipments and materials for missing or damaged components and hardware. Contact Customer Service at 508-836-0280 with Emseal's order number and invoice for prompt assistance.
- 3) Inspect substrate or adjacent construction for acceptance before beginning work. Report unacceptable construction to the project manager for scheduled repair work.
- 4) Review Emseal shop drawings for project specific detailed information if Engineering services were purchased at time of order.

Product Components

Components shown below vary in size depending on model of system.

Primer and Adhesives are **NOT** included in the **system pricing** and

ONLY required as an **accessory** when **splicing** the CWWF seal:



241F Adhesive, P/n: 2716



PP Primer for 241F Adhesive, P/n: 2717

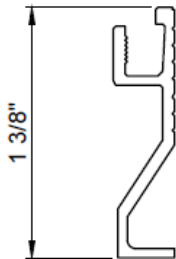

CWWF Wall Mount Aluminum Extrusion P/n: 20401

Optional components for splice procedures. Place order for required quantities.

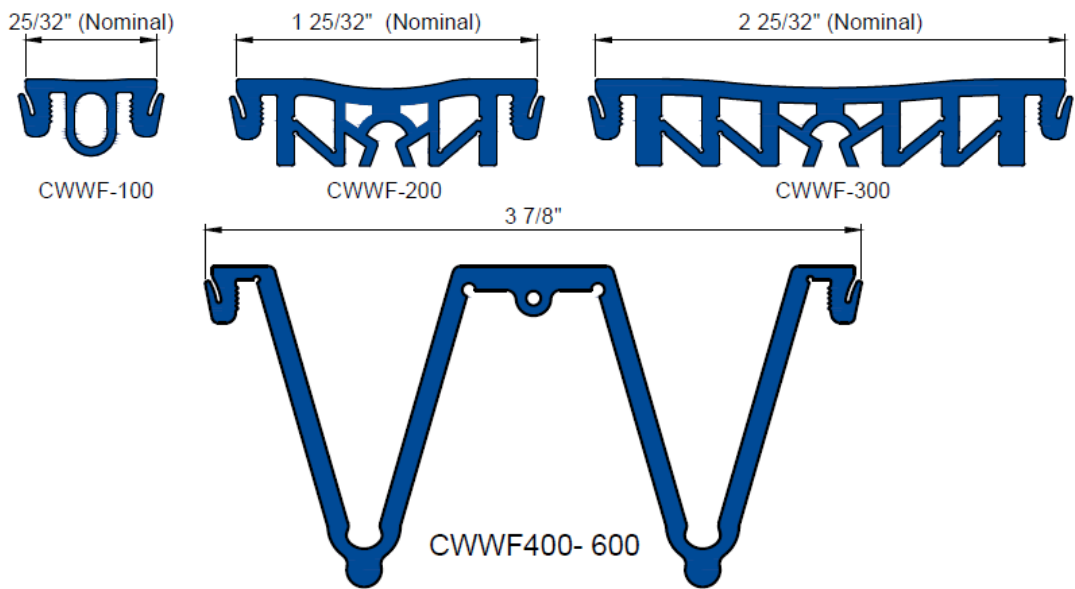

Part Number				
Model	Black Seal	White Seal	Beige Seal	Grey Seal
CWWF-100/100C	17501	17504	17503	17502
CWWF-200/200C	17601	17604	17603	17602
CWWF-300/300C	17701	17704	17703	17702
CWWF-400/400C	17401	17404	17403	17402
CWWF-500/500C	17401	17404	17403	17402
CWWF-600/600C	17401	17404	17403	17402



Installation

- 1

Prior to beginning work, installer shall inspect for proper wall construction. Verify joint opening is as called for on chart.

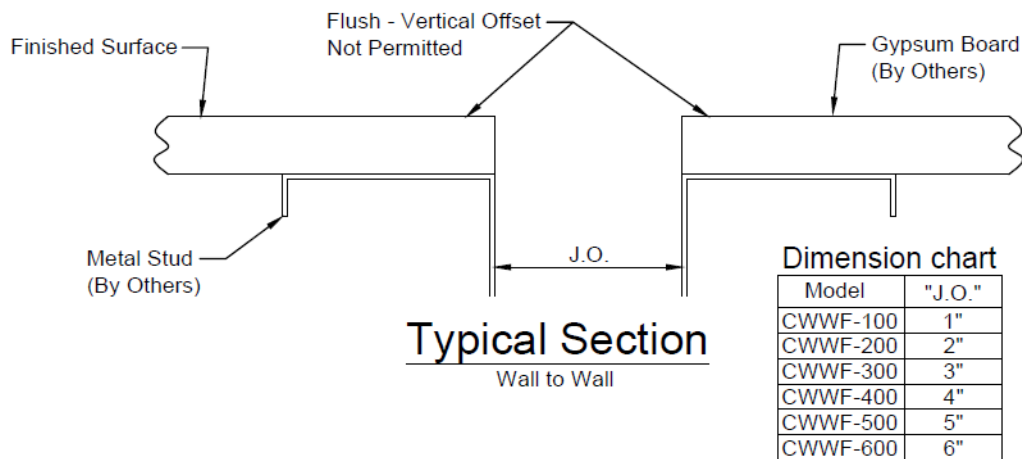

- 2

Place aluminum wall extrusion on edge of opening as shown. Utilizing drill bit, drill through extrusion, drywall, and into stud. Fasten with drywall screws (by contractor) spaced at 24" o.c. maximum, start 6" from ends.

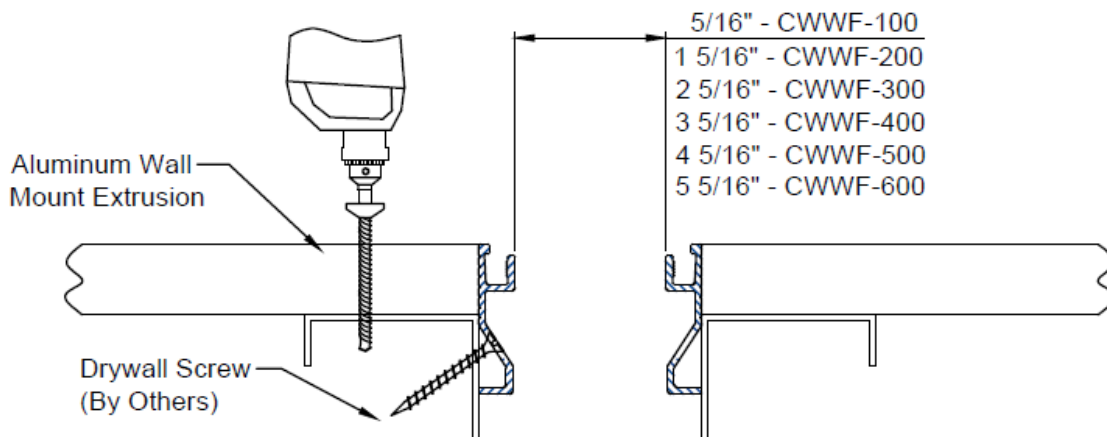

3

After completing installation of aluminum wall extrusion, snap lugs of seal into extrusion cavity on both sides of the joint.

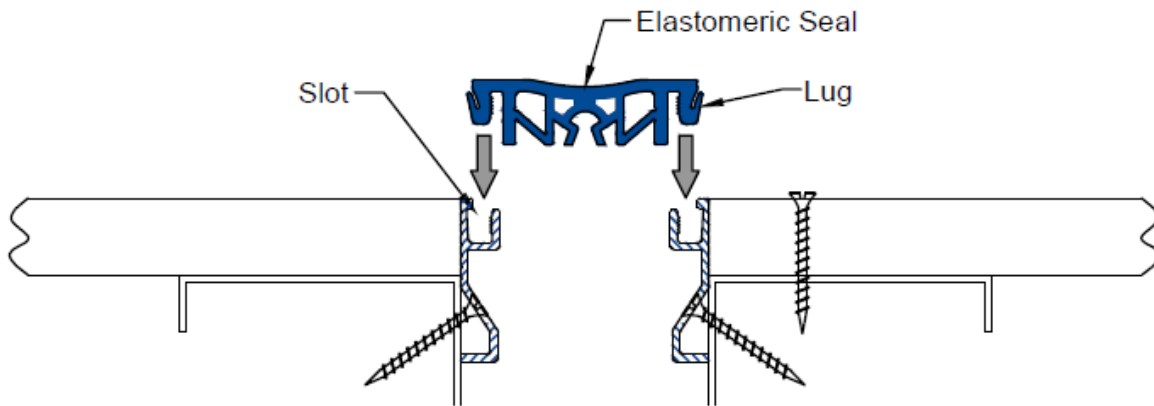

Suggested Field Splice Procedure

1. Cut ends of seal with a sharp knife and miter box to the desired angle. Ensure that cuts are clean and straight.
2. Clean ends of seal with a solvent.
3. Brush apply PP Primer to both seal ends to be joined.
4. Apply 241F Adhesive to one of the two seal ends to be bonded.
5. Apply pressure, bringing the two surfaces into tight contact immediately after adhesive is applied. Hold in place for one to two minutes for initial bond.
6. Re-check quality of all splices/miters and apply adhesive as required.
7. It is usually recommended to allow 15 minutes prior to installing seal. To achieve proper working strength, care shall be exercised since it takes 24 hours for adhesive to fully cure.



241F Adhesive



PP Primer

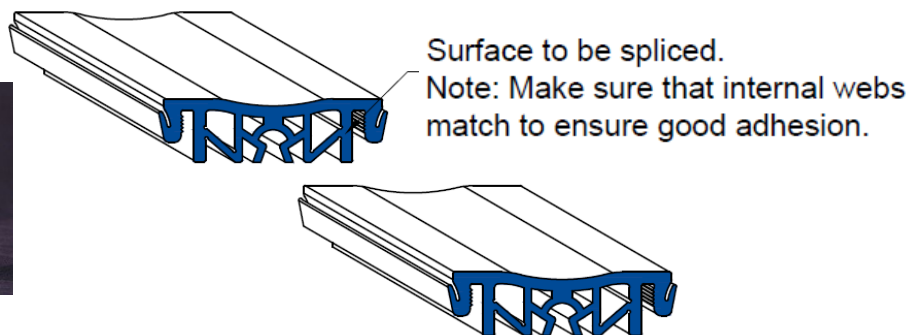

Information provided herein, including but not limited to, any drawing, design, photograph, graphic, or statement(s) ("Materials") are proprietary and the property of Sika Emseal. ("Company"). Reproduction, translation, or reduction to any electronic medium or machine readable form, in whole or part, is strictly prohibited, except for the express purpose for which it has been furnished, without prior written consent of Company. All Materials contained herein are provided by Company for information purposes only. Company reserves the right to amend or withdraw any information contained in the Materials without notice. All technical or other advice by Company, whether verbal or written, concerning products, or the use of products in specific situations ("Advice") is given by Company and is used at the User's own risk.



BUILDING TRUST





BUILDING TRUST



Installation Procedure

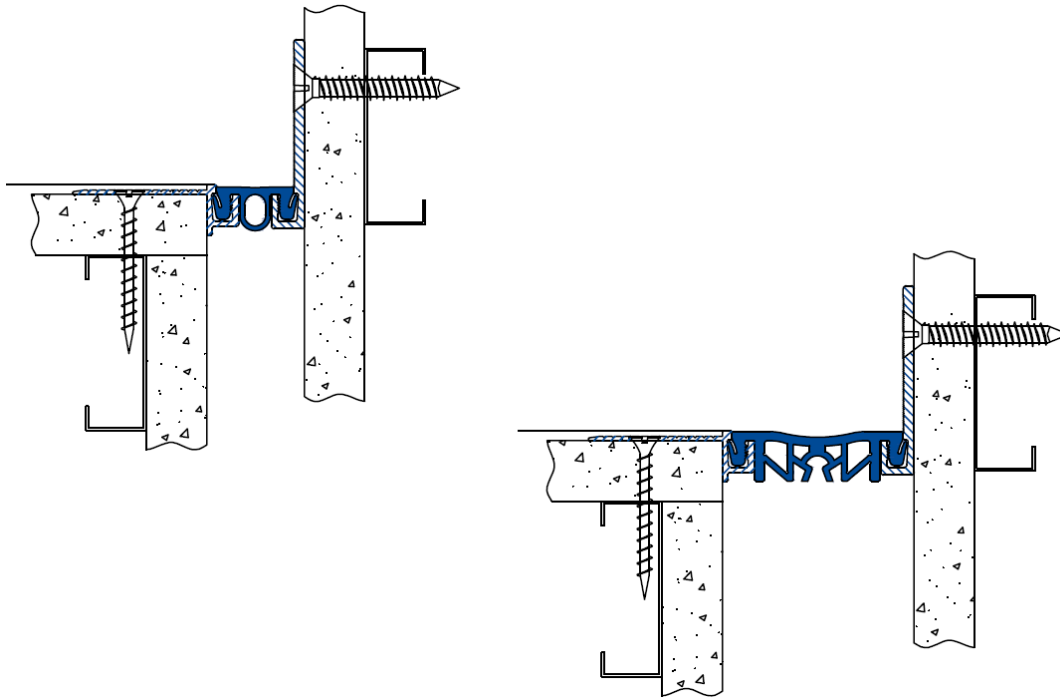

Wabo®CorridorWrap, "CWWE" Vertical Expansion Joint System

The following installation procedure is very important and must be fully understood prior to beginning any work. To ensure proper installation and performance of expansion joint system the following actions must be completed by the installing contractor. Failure to do so will affect product warranty.

- 1) Carefully read and understand installation procedure. Contact Sika Emseal's Technical Service Department at 508-836-0280 for product assistance.
- 2) Inspect all shipments and materials for missing or damaged components and hardware. Contact Customer Service at 508-836-0280 with Emseal's order number and invoice for prompt assistance.
- 3) Inspect substrate or adjacent construction for acceptance before beginning work. Report unacceptable construction to the project manager for scheduled repair work.
- 4) Review Emseal shop drawings for project specific detailed information if Engineering services were purchased at time of order.

Product Components

Components shown below vary in size depending on model of system.

Primer and Adhesives are **NOT** included in the system pricing and **ONLY** required as an accessory when splicing the CWWE seal:

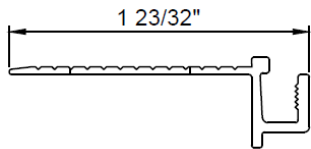

CWWE Aluminum Wall Extrusion P/n - 20402



CWWE Aluminum Corner Wall Extrusion P/n: 1615



241F Adhesive, P/n: 2716



PP Primer for 241F Adhesive, P/n: 2717

~ Optional components for splice procedures. Place order for required quantities.

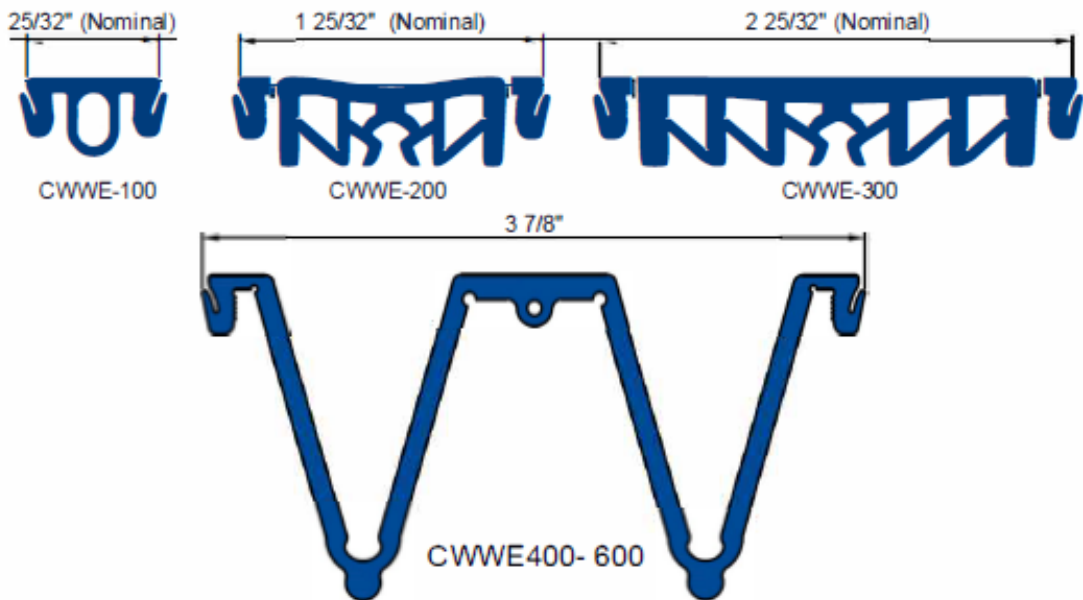

Part Number				
Model	Black Seal	White Seal	Beige Seal	Grey Seal
CWWE-100	17501	17504	17503	17502
CWWE-200	17601	17604	17603	17602
CWWE-300	17701	17704	17703	17702
CWWE-400	17401	17404	17403	17402
CWWE-500	17401	17404	17403	17402
CWWE-600	17401	17404	17403	17402



Installation

- 1

Prior to beginning work, installer shall inspect for proper wall construction. Verify joint opening is as called for on chart.

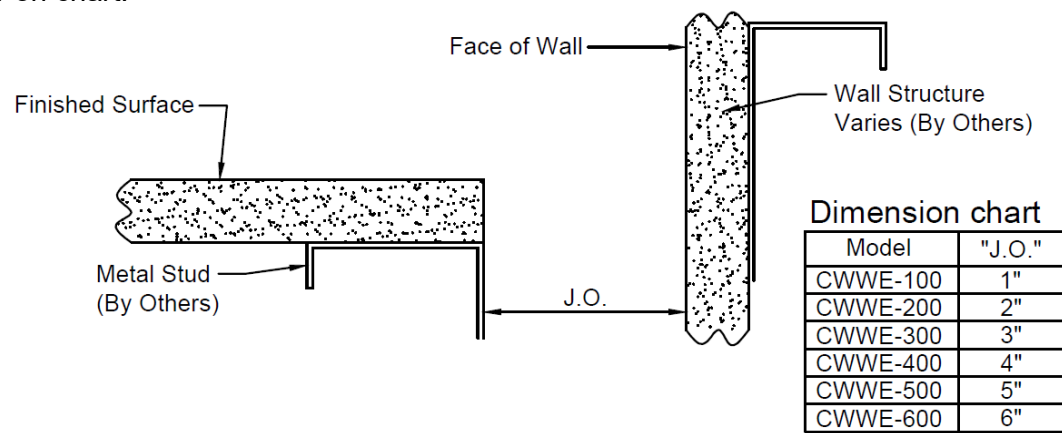

- 2

For installation of Aluminum Corner Wall Extrusion, utilize a suitable anchor (By Others) spaced at 24" Max. O.C. based upon the wall construction.
Note: Corner Wall Extrusion is not pre-drilled by the manufacturer.

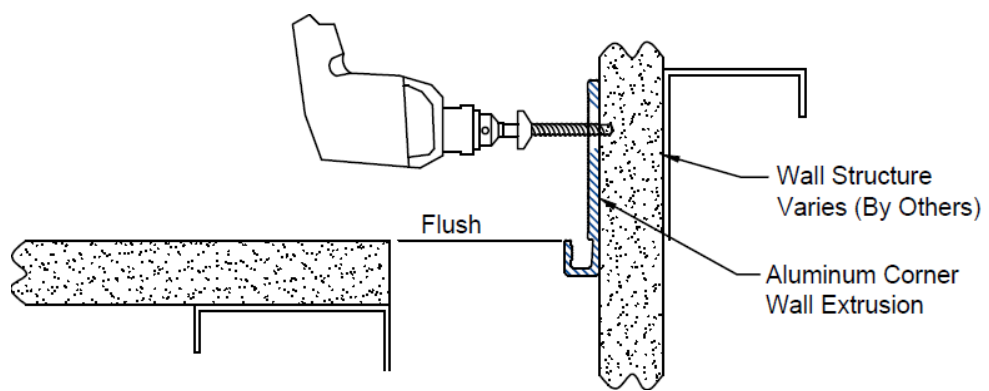

3

After completing installation of Aluminum Corner Wall Extrusion, install Aluminum Wall Extrusion to the building's wall structure.

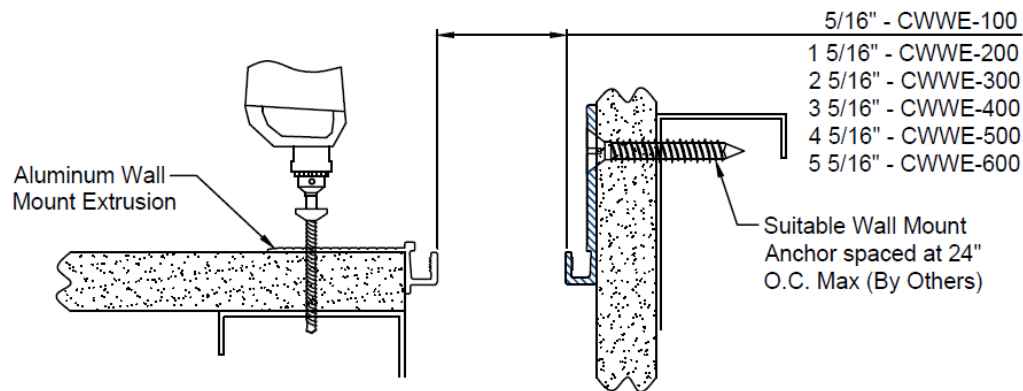

4

Insert Elastomeric Seal into slots of the Aluminum Wall and Corner Wall Extrusion, exercising care not to damage Elastomeric Seal.

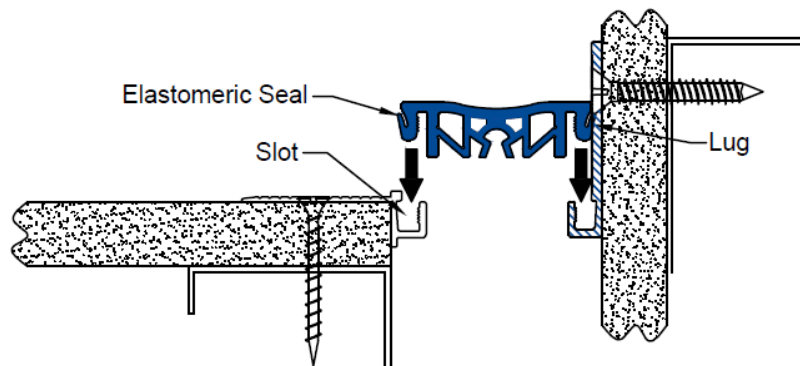

5

Installer shall finish aluminum extrusion flange with a coat of joint compound (provided by others).

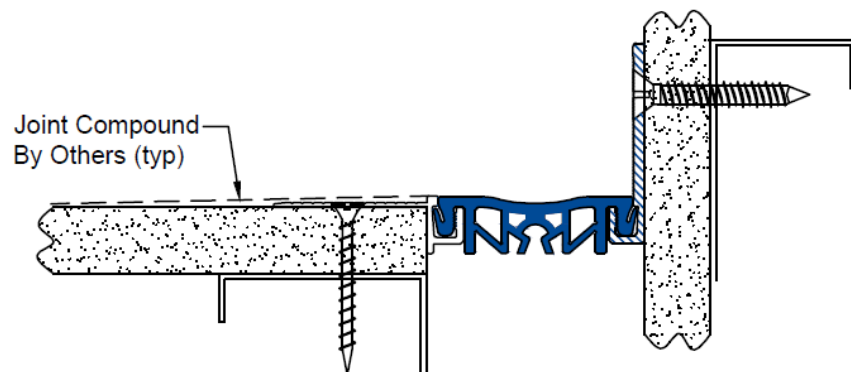

Suggested Field Splice Procedure

1. Cut ends of seal with a sharp knife and miter box to the desired angle. Ensure that cuts are clean and straight.
2. Clean ends of seal with a solvent.
3. Brush apply PP Primer to both seal ends to be joined.
4. Apply 241F Adhesive to one of the two seal ends to be bonded.
5. Apply pressure, bringing the two surfaces into tight contact immediately after adhesive is applied. Hold in place for one to two minutes for initial bond.
6. Re-check quality of all splices/miters and apply adhesive as required.
7. It is usually recommended to allow 15 minutes prior to installing seal. To achieve proper working strength, care shall be exercised since it takes 24 hours for adhesive to fully cure.



241F Adhesive



PP Primer

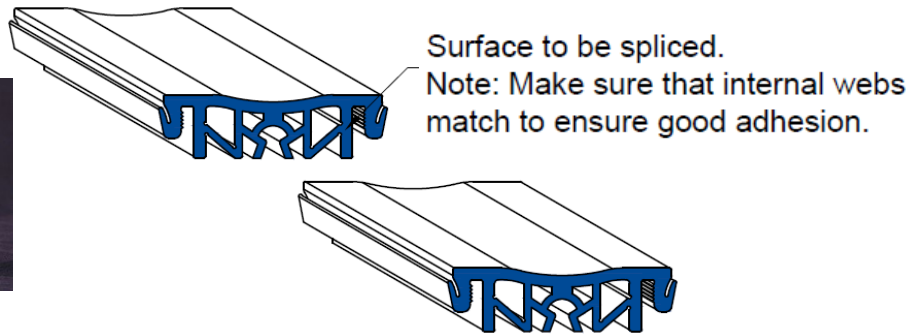

Information provided herein, including but not limited to, any drawing, design, photograph, graphic, or statement(s) ("Materials") are proprietary and the property of Sika Emseal. ("Company"). Reproduction, translation, or reduction to any electronic medium or machine readable form, in whole or part, is strictly prohibited, except for the express purpose for which it has been furnished, without prior written consent of Company. All Materials contained herein are provided by Company for information purposes only. Company reserves the right to amend or withdraw any information contained in the Materials without notice. All technical or other advice by Company, whether verbal or written, concerning products, or the use of products in specific situations ("Advice") is given by Company and is used at the User's own risk.

Sika Emseal
25 Bridle Lane, Westborough, MA 01581 USA
Phone: 508-836-0280 / Fax 508-836-0281
www.emseal.com

Rev. 1.1 - 8-22-2024



BUILDING TRUST





BUILDING TRUST



Installation Procedure

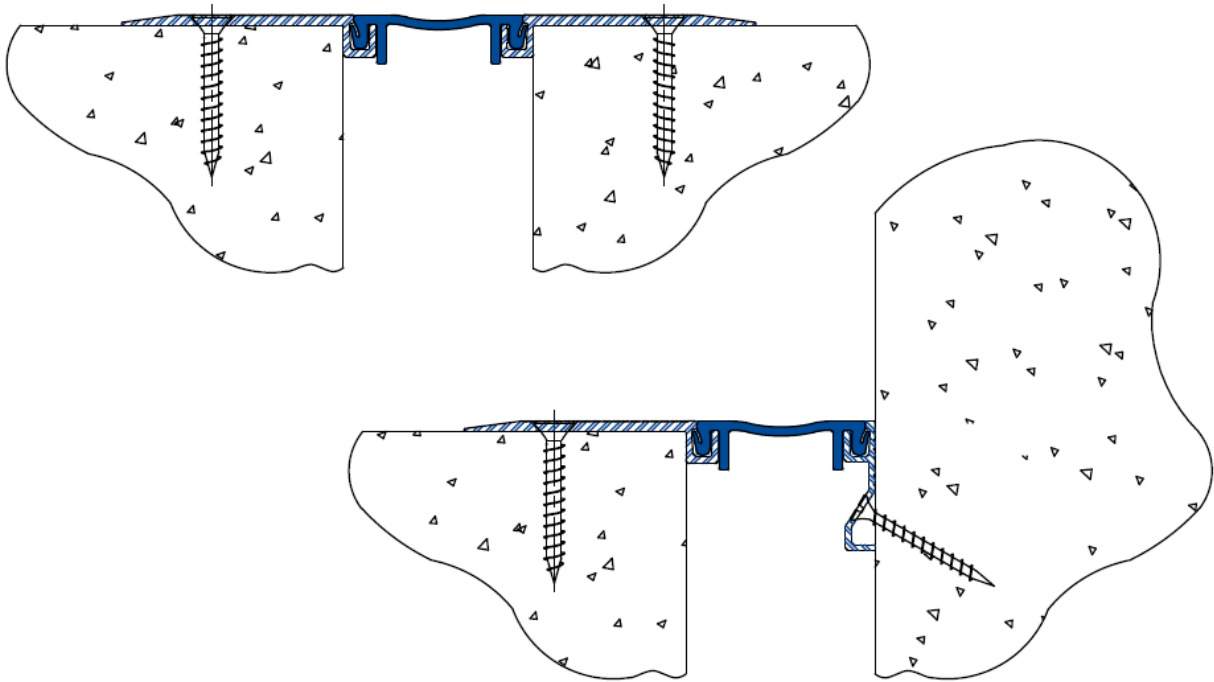

Wabo®CorridorWrap, “CWWM” & “CWWM-C” Vertical Expansion Joint System

The following installation procedure is very important and must be fully understood prior to beginning any work. To ensure proper installation and performance of expansion joint system the following actions must be completed by the installing contractor. Failure to do so will affect product warranty.

- 1) Carefully read and understand installation procedure. Contact Sika Emseal's Technical Service Department at 508-836-0280 for product assistance.
- 2) Inspect all shipments and materials for missing or damaged components and hardware. Contact Customer Service at 508-836-0280 with Emseal's order number and invoice for prompt assistance.
- 3) Inspect substrate or adjacent construction for acceptance before beginning work. Report unacceptable construction to the project manager for scheduled repair work.
- 4) Review Sika Emseal shop drawings for project specific detailed information if Engineering services were purchased at time of order.

Product Components

Components shown below vary in size depending on model of system.

Primer and Adhesives are **NOT** included in the system pricing and **ONLY** required as an accessory when splicing the CWWM seal:

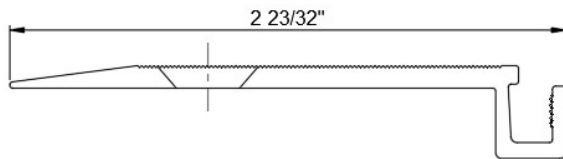

CWWM Wall Mount Aluminum Extrusion P/N - 1604

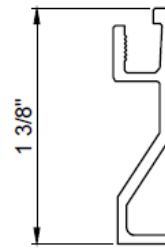

* CWWC Corner Wall Mount Aluminum Extrusion P/n: 20401



~ 241F Adhesive, P/n: 2716



~ PP Primer for 241F Adhesive, P/n: 2717

~ Optional components for splice procedures. Place order for required quantities.

* Components required for corner condition

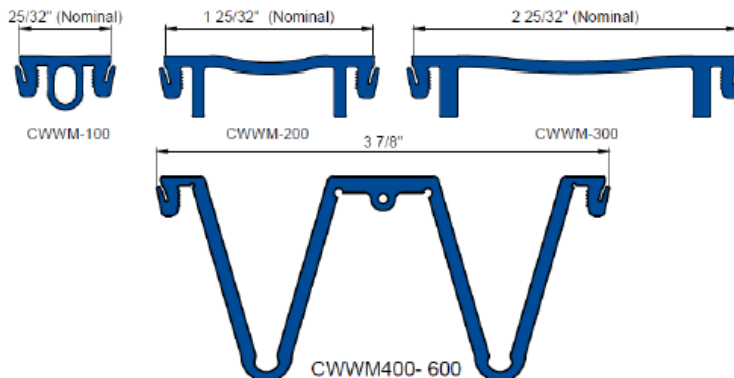

Part Number				
Model	Black Seal	White Seal	Beige Seal	Grey Seal
CWWM-100/100C	17501	17504	17503	17502
CWWM-200/200C	17605	17608	17607	17606
CWWM-300/300C	17705	17708	17707	17706
CWWM-400/400C	17401	17404	17403	17402
CWWM-500/500C	17401	17404	17403	17402
CWWM-600/600C	17401	17404	17403	17402



BUILDING TRUST



Installation (Wall-to-Wall)

- 1

Prior to beginning work, installer shall inspect for proper wall construction. Verify joint opening is as called for on chart.

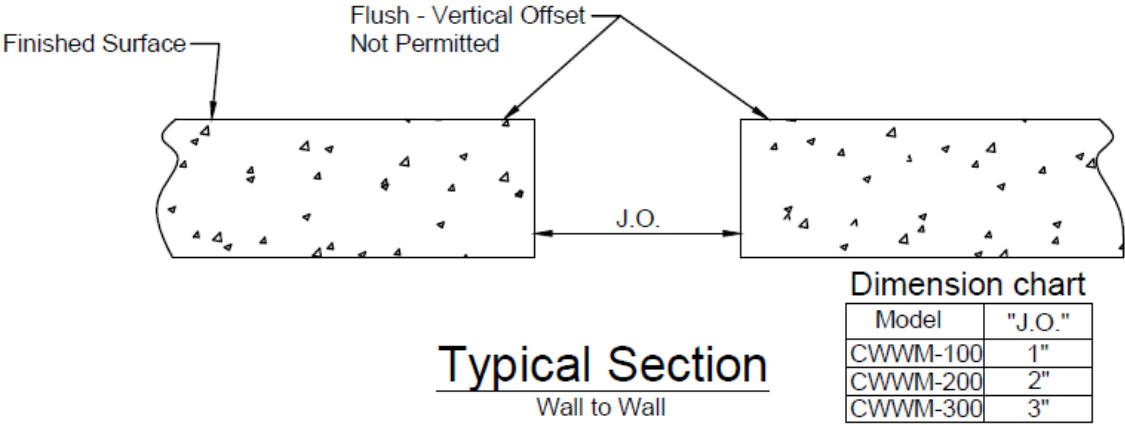

- 2

Place aluminum wall extrusion on edge of opening as shown. Utilizing drill bit, drill through extrusion, and into stud. Fasten with anchors (by contractor) spaced at 24" o.c. maximum, start 6" from ends.

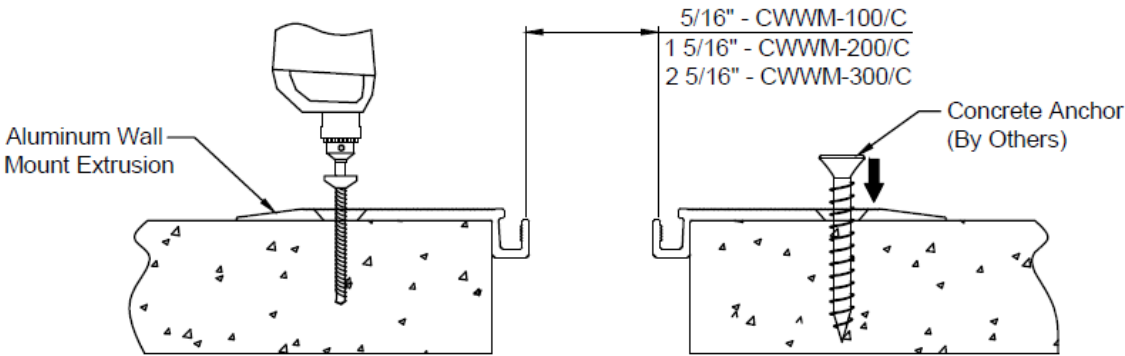

- 3

After completing installation of aluminum wall extrusion, snap lugs of seal into extrusion cavity on both sides of the joint .

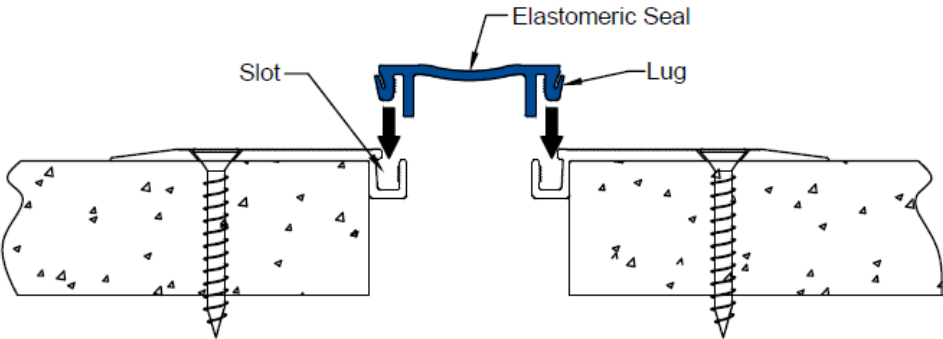

Installation (Corner Condition)

- 1

Prior to beginning work, installer shall inspect for proper wall construction. Verify joint opening is as called for on chart.

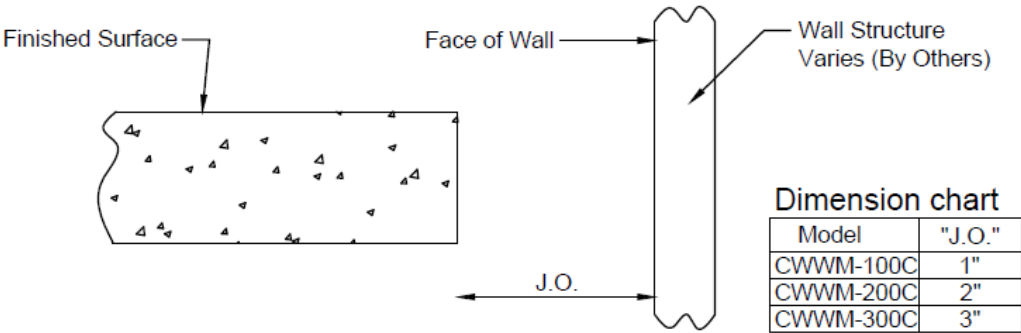

- 2

For installation of Wall Mount Aluminum Extrusion, utilize a suitable anchor (By Others) spaced at 24" Max. O.C. based upon the wall construction.
Note: Wall Mount Extrusion is not pre-drilled by the manufacturer.

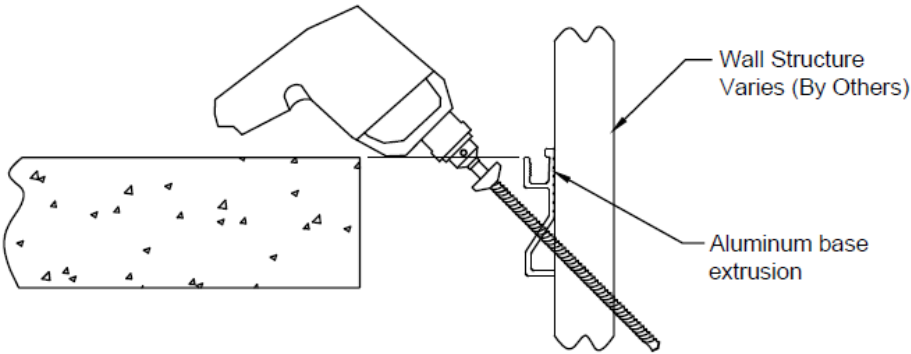

- 3

After completing installation of aluminum corner extrusions, install aluminum wall extrusion according to flush wall instructions.

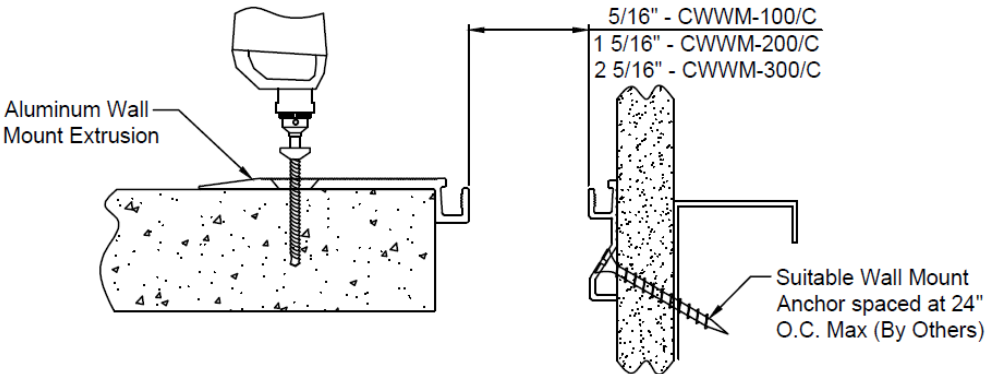

4

Insert Elastomeric Seal into slots of the Aluminum Base Extrusion, exercising care not to damage Elastomeric Seal.

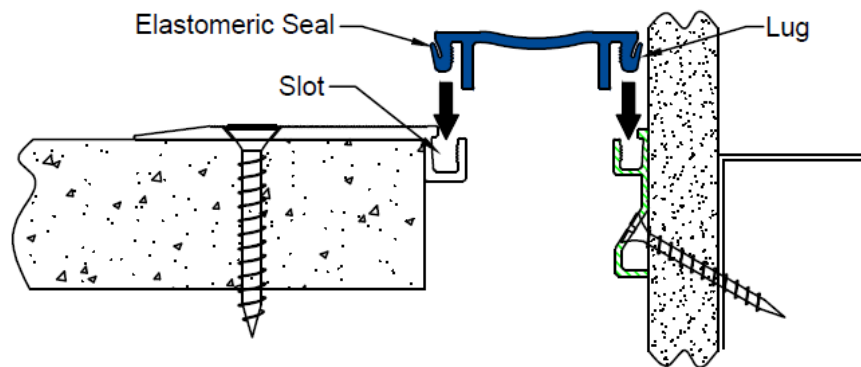

5

Finished view.

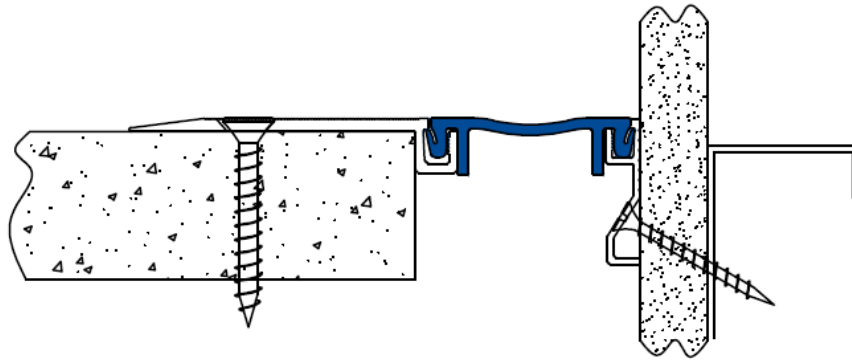

Suggested Field Splice Procedure

1. Cut ends of seal with a sharp knife and miter box to the desired angle. Ensure that cuts are clean and straight.
2. Clean ends of seal with a solvent.
3. Brush apply PP Primer to both seal ends to be joined.
4. Apply 241F Adhesive to one of the two seal ends to be bonded.
5. Apply pressure, bringing the two surfaces into tight contact immediately after adhesive is applied. Hold in place for one to two minutes for initial bond.
6. Re-check quality of all splices/miters and apply adhesive as required.
7. It is usually recommended to allow 15 minutes prior to installing seal. To achieve proper working strength, care shall be exercised since it takes 24 hours for adhesive to fully cure.



241F Adhesive



PP Primer

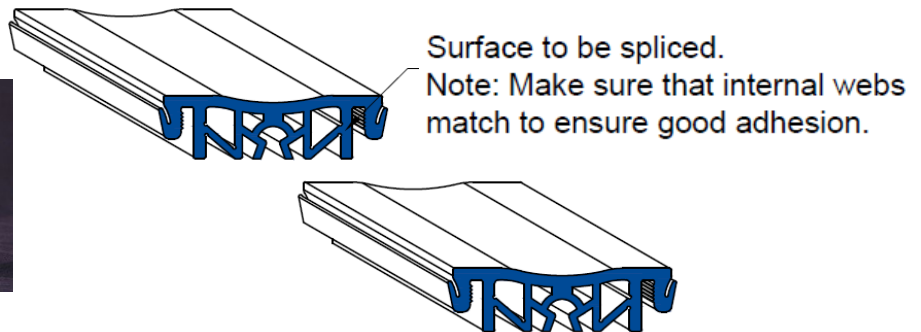

Information provided herein, including but not limited to, any drawing, design, photograph, graphic, or statement(s) ("Materials") are proprietary and the property of Sika Emseal. ("Company"). Reproduction, translation, or reduction to any electronic medium or machine readable form, in whole or part, is strictly prohibited, except for the express purpose for which it has been furnished, without prior written consent of Company. All Materials contained herein are provided by Company for information purposes only. Company reserves the right to amend or withdraw any information contained in the Materials without notice. All technical or other advice by Company, whether verbal or written, concerning products, or the use of products in specific situations ("Advice") is given by Company and is used at the User's own risk.

Sika Emseal
25 Bridle Lane, Westborough, MA 01581 USA
Phone: 508-836-0280 / Fax 508-836-0281
www.emseal.com

Rev. 1.1 08-22-2024



BUILDING TRUST





BUILDING TRUST



Installation Procedure

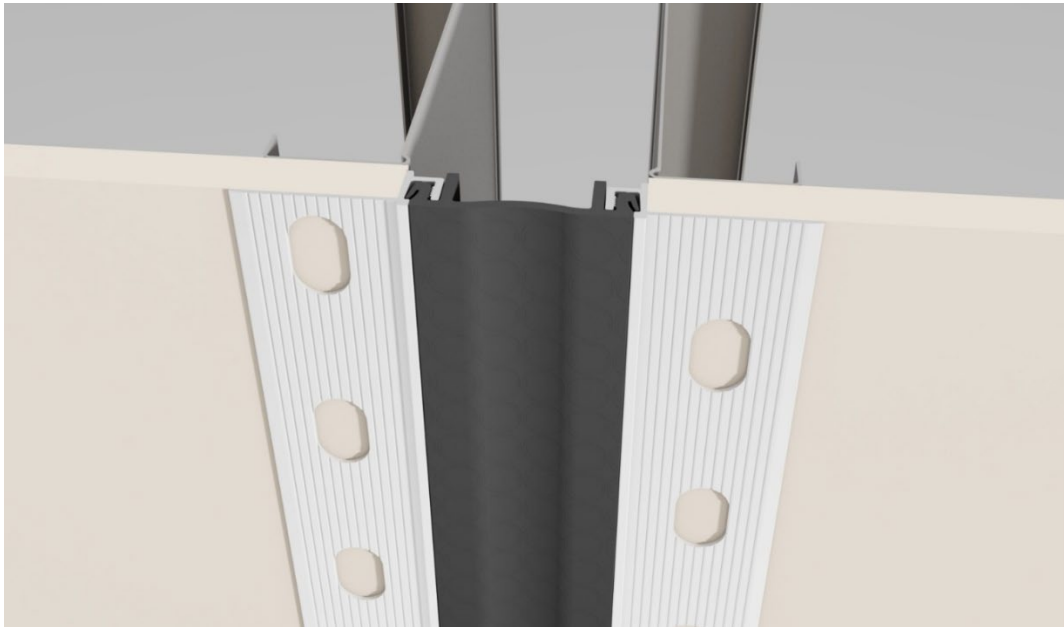

Wabo®CorridorWrap, “CWWS” & “CWWS-C” Vertical Expansion Joint System

The following installation procedure is very important and must be fully understood prior to beginning any work. To ensure proper installation and performance of expansion joint system the following actions must be completed by the installing contractor. Failure to do so will affect product warranty.

- 1) Carefully read and understand installation procedure. Contact Sika Emseal's Technical Service Department at 508-836-0280 for product assistance.
- 2) Inspect all shipments and materials for missing or damaged components and hardware. Contact Customer Service at 508-836-0280 with Emseal's order number and invoice for prompt assistance.
- 3) Inspect substrate or adjacent construction for acceptance before beginning work. Report unacceptable construction to the project manager for scheduled repair work.
- 4) Review Emseal shop drawings for project specific detailed information if Engineering services were purchased at time of order.

Product Components

Components shown below vary in size depending on model of system.
Primer and Adhesives are **NOT** included in the **system pricing** and **ONLY** required as an accessory when **splicing** the CWWS seal:

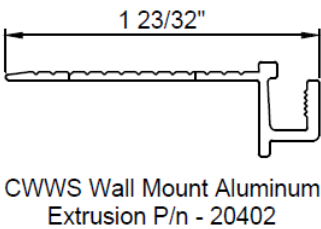
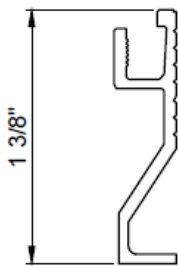

* CWWS Corner Wall Mount
 Aluminum Extrusion P/n: 20401



241F Adhesive, P/n:
 2716



PP Primer for 241F
 Adhesive, P/n: 2717

Optional components for splice procedures. Place order for required quantities.

* Components required for corner condition

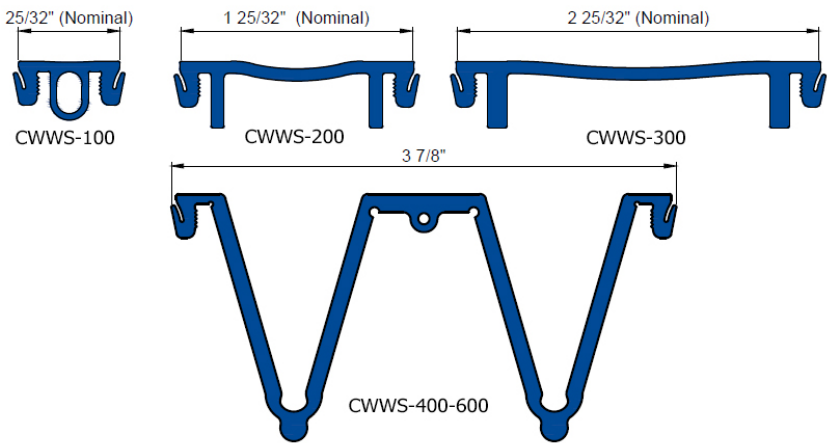

Model	Part Number			
	Black Seal	White Seal	Beige Seal	Grey Seal
CWWS-100/100C	17501	17504	17503	17502
CWWS-200/200C	17605	17608	17607	17606
CWWS-300/300C	17705	17708	17707	17706
CWWS-400/400C	17401	17404	17403	17402
CWWS-500/500C	17401	17404	17403	17402
CWWS-600/600C	17401	17404	17403	17402



Installation (Wall-to-Wall)

1

Prior to beginning work, installer shall inspect for proper wall construction. Verify joint opening is as called for on chart.

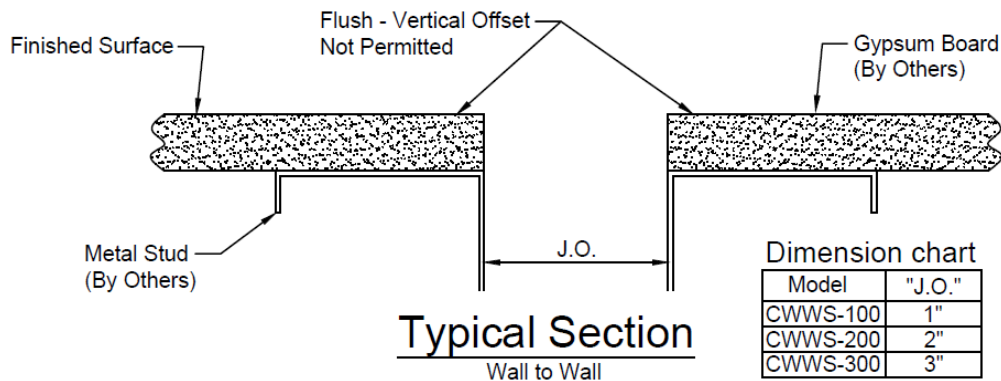

2

Place aluminum wall extrusion on edge of opening as shown. Utilizing drill bit, drill through extrusion, drywall, and into stud. Fasten with drywall screws (by contractor) spaced at 24" o.c. maximum, start 6" from ends.

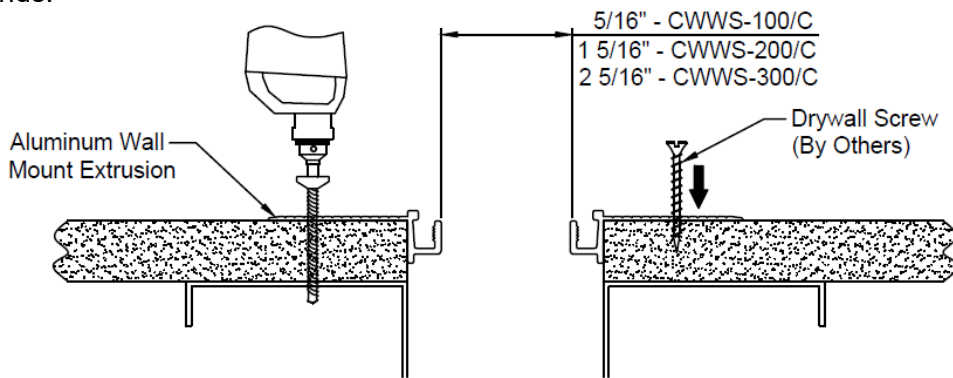

3

After completing installation of aluminum wall extrusion, snap lugs of seal into extrusion cavity on both sides of the joint .

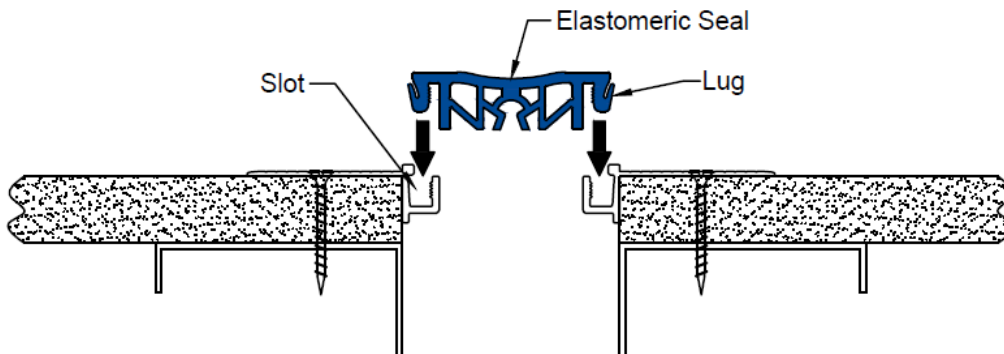

BUILDING TRUST



4

Installer shall finish aluminum extrusion flange with a coat of joint compound (provided by others).

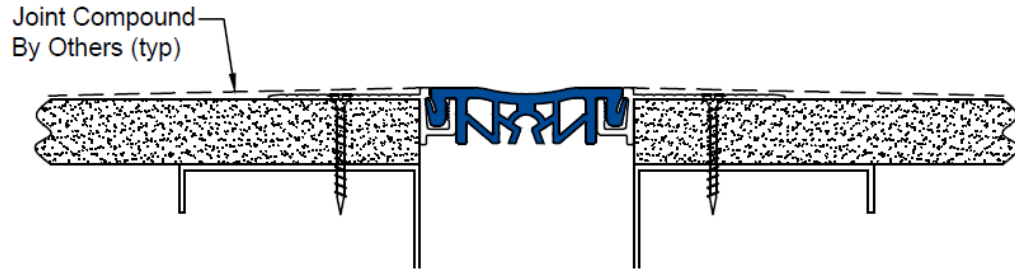

Installation (Corner Condition)

1

Prior to beginning work, installer shall inspect for proper wall construction. Verify joint opening is as called for on chart.

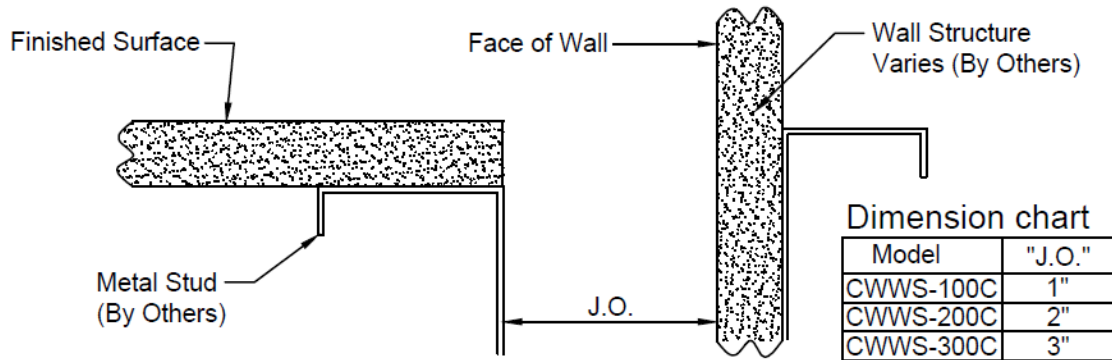

2

For installation of Wall Mount Aluminum Extrusion, utilize a suitable anchor (By Others) spaced at 24" Max. O.C. based upon the wall construction.

Note: Wall Mount Extrusion is not pre-drilled by the manufacturer.

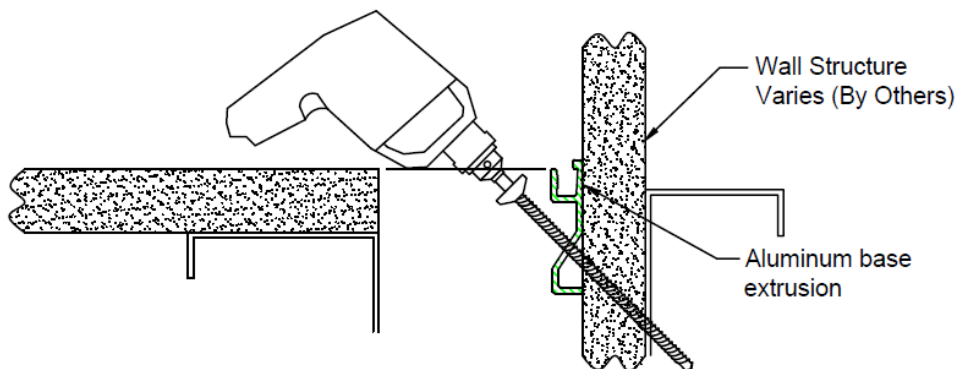

3

After completing installation of aluminum corner extrusions, install aluminum wall extrusion according to flush wall instructions.

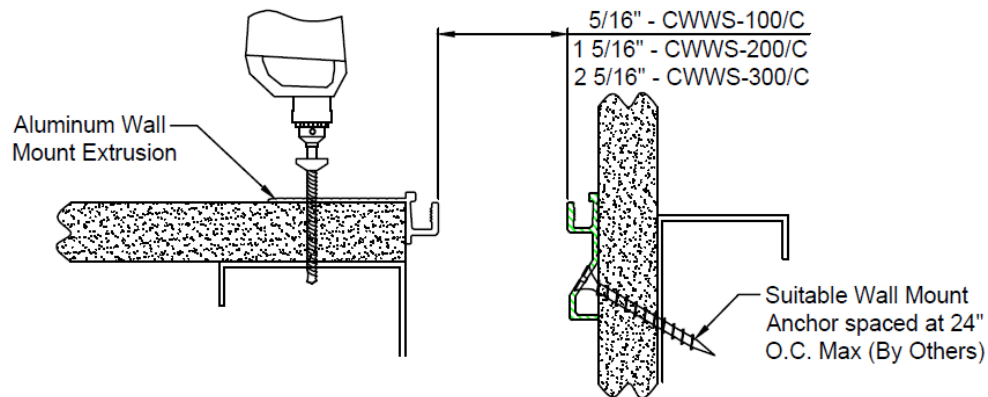

4

Insert Elastomeric Seal into slots of the Aluminum Base Extrusion, exercising care not to damage Elastomeric Seal.

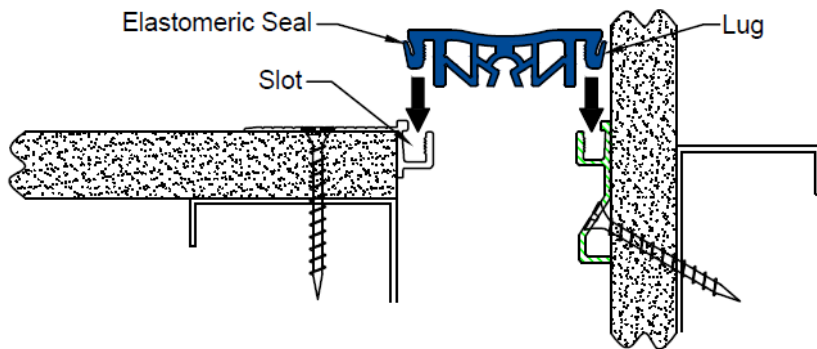

5

Installer shall finish aluminum extrusion flange with a coat of joint compound (provided by others).

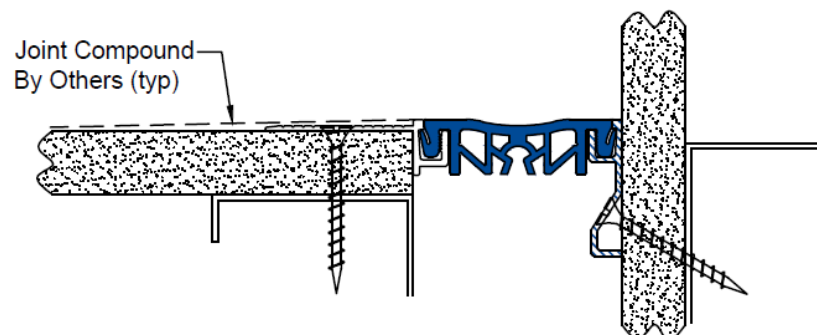

BUILDING TRUST



Suggested Field Splice Procedure

1. Cut ends of seal with a sharp knife and miter box to the desired angle. Ensure that cuts are clean and straight.
2. Clean ends of seal with a solvent.
3. Brush apply PP Primer to both seal ends to be joined.
4. Apply 241F Adhesive to one of the two seal ends to be bonded.
5. Apply pressure, bringing the two surfaces into tight contact immediately after adhesive is applied. Hold in place for one to two minutes for initial bond.
6. Re-check quality of all splices/miters and apply adhesive as required.
7. It is usually recommended to allow 15 minutes prior to installing seal. To achieve proper working strength, care shall be exercised since it takes 24 hours for adhesive to fully cure.



241F Adhesive



PP Primer

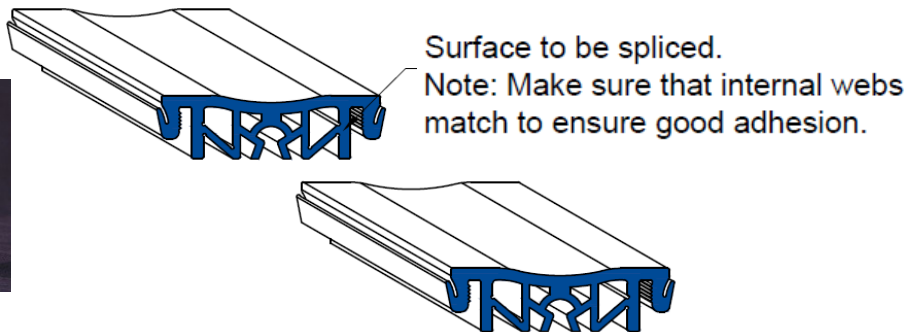

Information provided herein, including but not limited to, any drawing, design, photograph, graphic, or statement(s) ("Materials") are proprietary and the property of Sika Emseal. ("Company"). Reproduction, translation, or reduction to any electronic medium or machine readable form, in whole or part, is strictly prohibited, except for the express purpose for which it has been furnished, without prior written consent of Company. All Materials contained herein are provided by Company for information purposes only. Company reserves the right to amend or withdraw any information contained in the Materials without notice. All technical or other advice by Company, whether verbal or written, concerning products, or the use of products in specific situations ("Advice") is given by Company and is used at the User's own risk.

Sika Emseal
25 Bridle Lane, Westborough, MA 01581 USA
Phone: 508-836-0280 / Fax 508-836-0281
www.emseal.com

Rev. 1.1 08-22-2024



BUILDING TRUST

