



BUILDING TRUST



PRODUCT DATA SHEET

SafeReseal®

Watertight precompressed, primary seal for grindless installation in retrofit EIFS sealant joints.

International Patent Pending

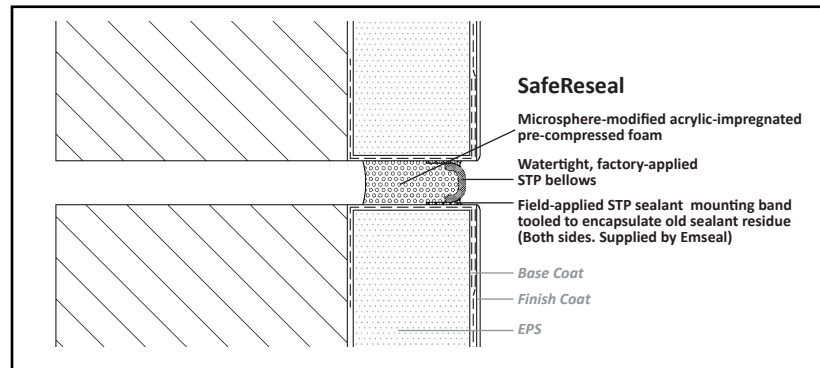

Product Description

A joint sealing system for EIFS, precast, and virtually any substrate, **SafeReseal®** by Sika Emseal is a safer, grindless, dustless, primerless, tensionless, **paintable**, retrofit joint sealant that **installs over old sealant residue without the requirement for grinding** to completely remove old sealant.

SafeReseal can also be used in new construction as a durable, paintable/coatable alternative to traditional liquid sealant and backer rod.

SafeReseal is factory coated with a premium grade, watertight, paintable, hybrid STP sealant and precompressed to less than the nominal material/joint size.

The STP sealant has been tested to achieve the requisite adhesion—while under compression from the backpressure of the impregnated foam backing—to the residue of a wide range of commonly supplied joint sealants regardless of age or state (cured, crazed, dried out, reverted, etc.).

Emseal SafeReseal can be installed in a variety of conditions without the need for grinding joint substrates. The elimination of grinding means less noise and less tenant/occupant disruption. The absence of dust means the absence of harmful airborne contaminants like silica and removes the requirement for dust containment, extraction equipment, or specialized respiratory personal protective equipment.

Old joint sealant is removed from the joints using a razor knife. Care is taken to remove as much old sealant as possible without damaging the underlying substrate. After a light solvent wipe, the old sealant is encapsulated with a tooled bead of the supplied STP sealant which acts as the mounting/bonding adhesive for SafeReseal.

The performance properties of SafeReseal are the same as those in Emseal's technology-defining, [Seismic Colorseal](#) precompressed foam technology. The single preformed product outperforms other technologies and provides a durable, watertight seal that creates a thermal block, acts as a sound attenuating barrier, and resists the effects of air pressure differentials, wind-driven rain, and other common forces that cause moisture ingress.

Uses

Retrofit of old sealant joints without the need for grinding to remove all old sealant residue from substrates including:

- EIFS
- Precast concrete
- CMU
- Masonry

Features

- Dustless
- Grindless
- Noiseless
- Primerless
- Tensionless
- Paintable
- Installs over old sealant residue (polyurethane, silicone, acrylic, or STPE)
- Smooth convex surface
- No priming, masking, mixing, tooling or backer rod placing
- Watertight / Insulates / Sound attenuating



SafeReseal® provides a 10-LF (3m) length on a single reel.

Benefits

- Quiet: no grinding required, so less occupant disruption
- Safer: no grinding means no silica or other airborne contaminants ensuring worker and building occupant safety
- Aesthetic Continuity: paintable coating receives acrylic-based wall coatings (such as Sikagard® 550W, Sikagard®-515 Elastomeric, Sikagard®-575 Aquasol)

Standard Sizes

- 1/2", 3/4", 1" and 1 1/4" (12, 20, 25 and 30mm)
- Depth of Seal: 1 3/4" (45mm)

Movement Capability & Joint Sizing

NOTE: while SafeReseal installed in a joint size that equals the nominal material size is capable of movement in excess of 100% (+50%, -50%), small sealant joints for which it is intended do not typically move this much. Consequently, this excess movement can be allocated to joint size variation. This allows installation of each size in a variety of joint sizes while minimizing material size switching. The allowed variation in joint size still leaves sufficient movement capability if used in the largest allowable joint opening for each size:

Nominal Material Size	Use in Joint Range
1/2" (12mm)	3/8" - 3/4" (10 - 20mm)
3/4" (20mm)	5/8" - 1" (15 - 25mm)
1" (25mm)	7/8" - 1-1/4" (23 - 30mm)
1-1/4" (30mm)	1" - 1-1/2" (25 - 40mm)

Roll Length: 10-LF (3m)

Colors

Paintable – SafeReseal is coated with a STP sealant in a standard, neutral "limestone" color. It can be used as-is or is ideal for accepting latex and acrylic paints and acrylic-based wall coatings (such as Sikagard® 550W, Sikagard®-515 Elastomeric, Sikagard®-575 Aquasol).

Composition

SafeReseal combines a factory-applied and cured hybrid STP sealant bellows with a microsphere-modified acrylic-impregnated expanding foam sealant backing.

Installation

NOTE: This is a summary installation sequence for illustration purposes only. See the [SafeReseal Installation Guide](#) for complete instructions.

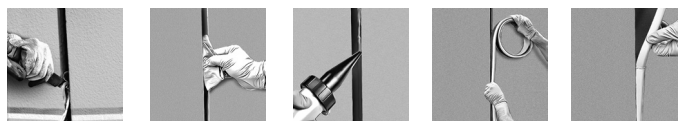

Preparation involves removal of old sealant from the joints using a razor knife. Care is taken to remove as much old sealant as possible without damaging the underlying substrate. The substrates, with old sealant residue, are wiped with acetone and clean, lint-free rags.

A 1/4" (6mm) wide mounting band of STP liquid sealant (supplied by Emseal) is applied to the substrate face and tooled with a caulk knife to encapsulate the old sealant residue.

SafeReseal is released from its spool and inserted into the joint. A clearance depth in the joint opening of 1-3/4" (45mm) must be available to receive all sizes of SafeReseal.

SafeReseal self-expands to embed into the still-wet sealant to complete the seal. Joints between lengths, and at transitions are made in compression and with the application of a light coating of STP sealant on the end of one of the joining faces.

Compatible with EIFS

SafeReseal is uniquely suited to resealing EIFS systems. Where old joint sealant was previously properly installed against EIFS basecoat and basecoat is sound, bonded and fully encapsulates the underlying reinforcing mesh, no grinding of substrates is necessary to remove residual sealant after cutting it out. If basecoat is damaged and or reinforcing mesh is exposed, this must be repaired and restored using appropriate methods and materials. If EIFS finish coat was returned onto the joint faces, this must be removed to basecoat and any damage to the basecoat repaired in accordance with appropriate methods and materials (consult EIFS manufacturer) before installing SafeReseal.



Warranty

Standard or project specific warranties are available from Sika Emseal on request.

Availability and Price

- Emseal SafeReseal is available for shipment internationally.
- Prices are available from [local representatives](#) and/or directly from the manufacturer.
- The product range is continually being updated, and accordingly Emseal reserves the right to modify or withdraw any product without prior notice.

Emseal JOINT SYSTEMS, LTD
25 Bridle Lane
Westborough, MA 01581 USA
Phone: 508.836.0280
Fax: 508.836.0281
www.Emseal.com

Emseal, LLC
111 Royal Group Crescent
Woodbridge, ON L4H 1X9 Canada
Phone: +1-416-740-2090
Fax: +1-416-740-0233
www.Emseal.com

SIKA CORPORATION
201 Polito Avenue
Lyndhurst, NJ 07071 USA
Phone: +1-800-933-7452
Fax: +1-2019336225
www.usa.sika.com

Product Data Sheet
Sika Emseal SafeReseal
July 2024 Version SE-2.0



BUILDING TRUST

