

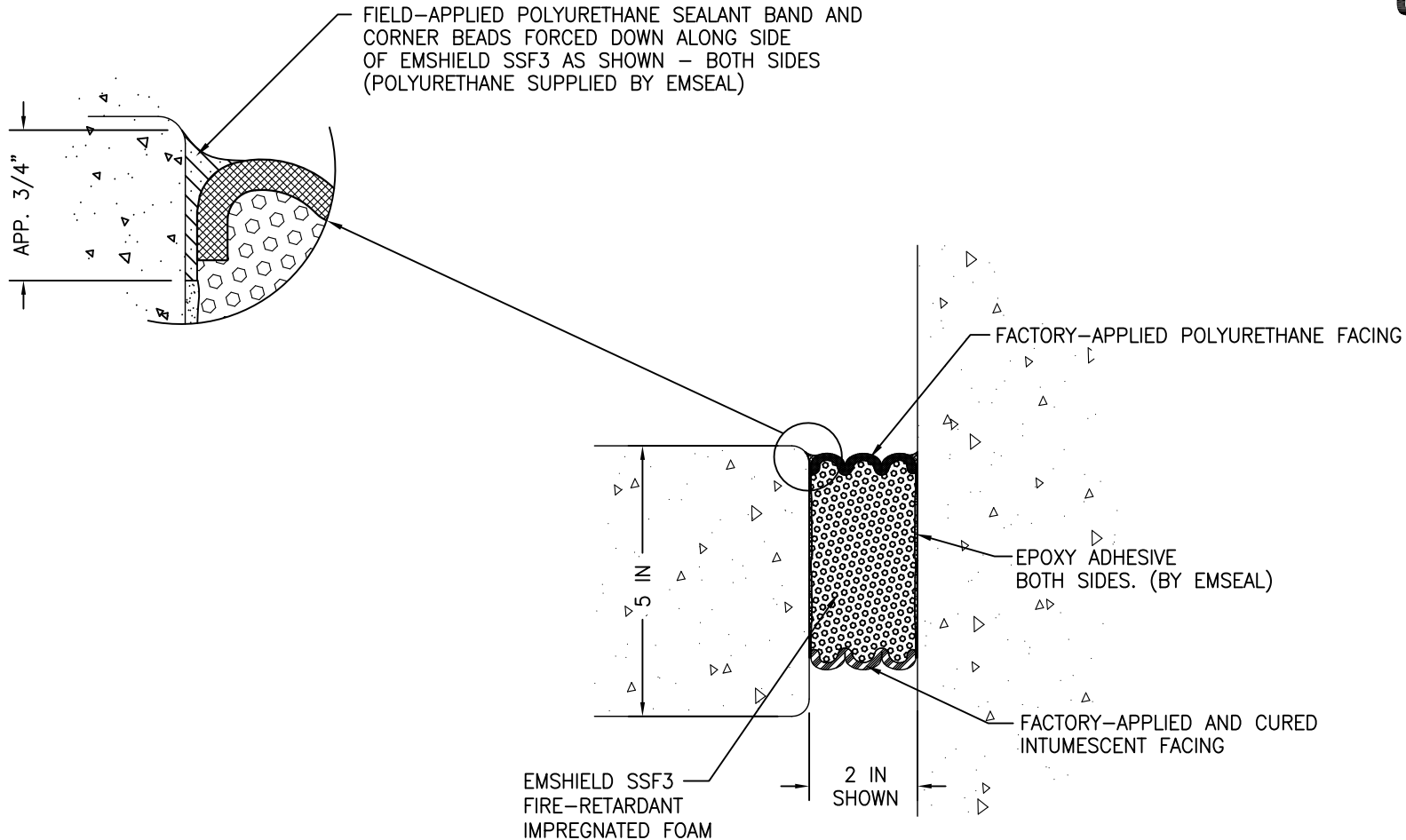

System # FW-D-0054

System # JF139



MOVEMENT: ±25% (TOTAL 50%) OF NOMINAL MATERIAL SIZE

EMSEAL'S EMSHIELD SSF3 HAS BEEN TESTED IN ACCORDANCE WITH UL 2079 IN THE CONFIGURATION DEPICTED IN UL SYSTEM # FW-D-0054 . USE OF THIS MATERIAL IN DECK ASSEMBLY CONFIGURATIONS OTHER THAN DEPICTED IN UL SYSTEM # FW-D-0054 WILL NOT ENCUMBER OR LOWER THE RESISTANCE OF THE DECK BUT IS DONE SO AT THE DESIGNERS' DISCRETION AND RESPONSIBILITY FOR DESIGN OF A FIRE RATED DECK ASSEMBLY THAT MEETS APPLICABLE STANDARDS FOR THE PROJECT.

EMSEAL JOINT SYSTEMS LTD.

EMSHIELD SSF3 DECK TO WALL

THIS DOCUMENT CONTAINS INFORMATION OF A CONFIDENTIAL NATURE UNAVAILABLE TO THE PUBLIC AND IS PROPRIETARY TO EMSEAL CORPORATION. ANY UNAUTHORIZED USE WILL BE PROSECUTED. THIS DRAWING IS PROTECTED BY COPYRIGHT, THE RIGHT TO REPRODUCE IN ANY FORM BEING THE EXCLUSIVE RIGHT OF EMSEAL CORPORATION. ANY UNAUTHORIZED REPRODUCTION WHETHER IN TWO OR THREE DIMENSIONS WILL BE PROSECUTED.

DRAWN BY: TAB	DATE: 2011/03/11	SCALE: N.T.S.	SHEET No: 1 OF 1
------------------	---------------------	------------------	---------------------

PART NUMBER:
EMSHIELD SSF3 2IN D-W X SECTION - 001