

EMSEAL JOINT SYSTEMS LTD.

ROOFJOINT 0200 - SEISMIC COLORSEAL SOLID-WALL CLOSURE

THIS DOCUMENT CONTAINS INFORMATION OF A CONFIDENTIAL NATURE AND IS PROPRIETARY TO EMSEAL JOINT SYSTEMS LTD. ANY UNAUTHORIZED USE WILL BE PROSECUTED. THIS DRAWING IS PROTECTED BY COPYRIGHT, THE RIGHT TO REPRODUCE IN ANY FORM BEING THE EXCLUSIVE RIGHT OF EMSEAL JOINT SYSTEMS LTD. ANY UNAUTHORIZED REPRODUCTION WHETHER IN TWO OR THREE DIMENSIONS WILL BE PROSECUTED. © 2014 EMSEAL JOINT SYSTEMS LTD.

DRAWN BY: JNM	DATE: 2014/01/10	SCALE: N.T.S.	SHEET No: 1 OF 2
------------------	---------------------	------------------	---------------------

PART NUMBER:
RJ-0200-COS-SOLID-WALL

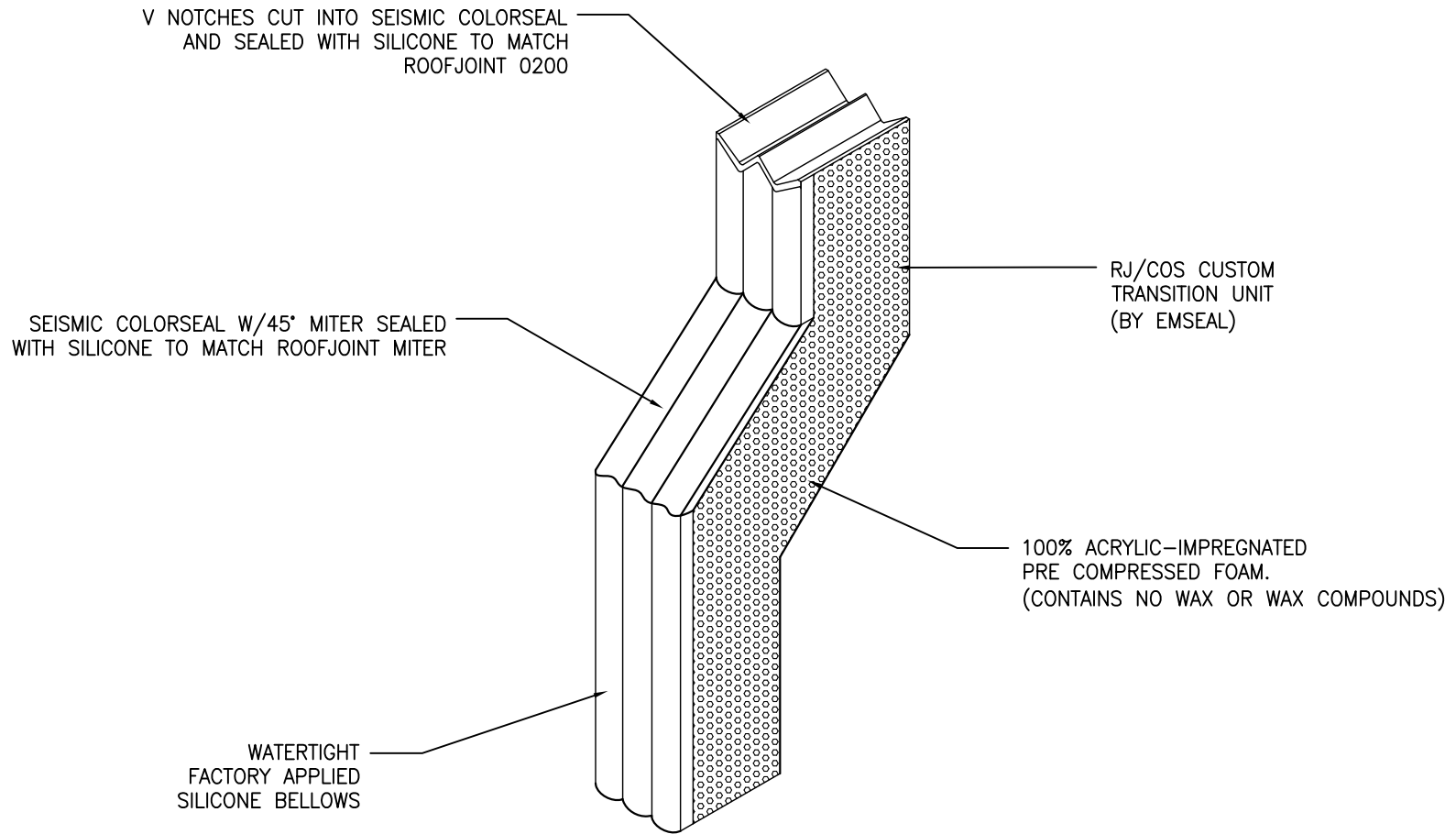

EMSEAL JOINT SYSTEMS LTD.

ROOFJOINT 0200 - SEISMIC COLORSEAL SOLID-WALL CLOSURE

THIS DOCUMENT CONTAINS INFORMATION OF A CONFIDENTIAL NATURE AND IS PROPRIETARY TO EMSEAL JOINT SYSTEMS LTD. ANY UNAUTHORIZED USE WILL BE PROSECUTED. THIS DRAWING IS PROTECTED BY COPYRIGHT, THE RIGHT TO REPRODUCE IN ANY FORM BEING THE EXCLUSIVE RIGHT OF EMSEAL JOINT SYSTEMS LTD. ANY UNAUTHORIZED REPRODUCTION WHETHER IN TWO OR THREE DIMENSIONS WILL BE PROSECUTED. © 2014 EMSEAL JOINT SYSTEMS LTD.

DRAWN BY: JNM	DATE: 2014/01/10	SCALE: N.T.S.	SHEET No: 2 OF 2
------------------	---------------------	------------------	---------------------

PART NUMBER:
RJ-0200-COS-SOLID-WALL