

FACTORY-APPLIED POLYURETHANE FACING
(NUMBER OF BELLOWS VARIES
WITH NOMINAL MATERIAL SIZE)

APPLY SILICONE AND INTUMESCENT
AT DIRECTION CHANGE

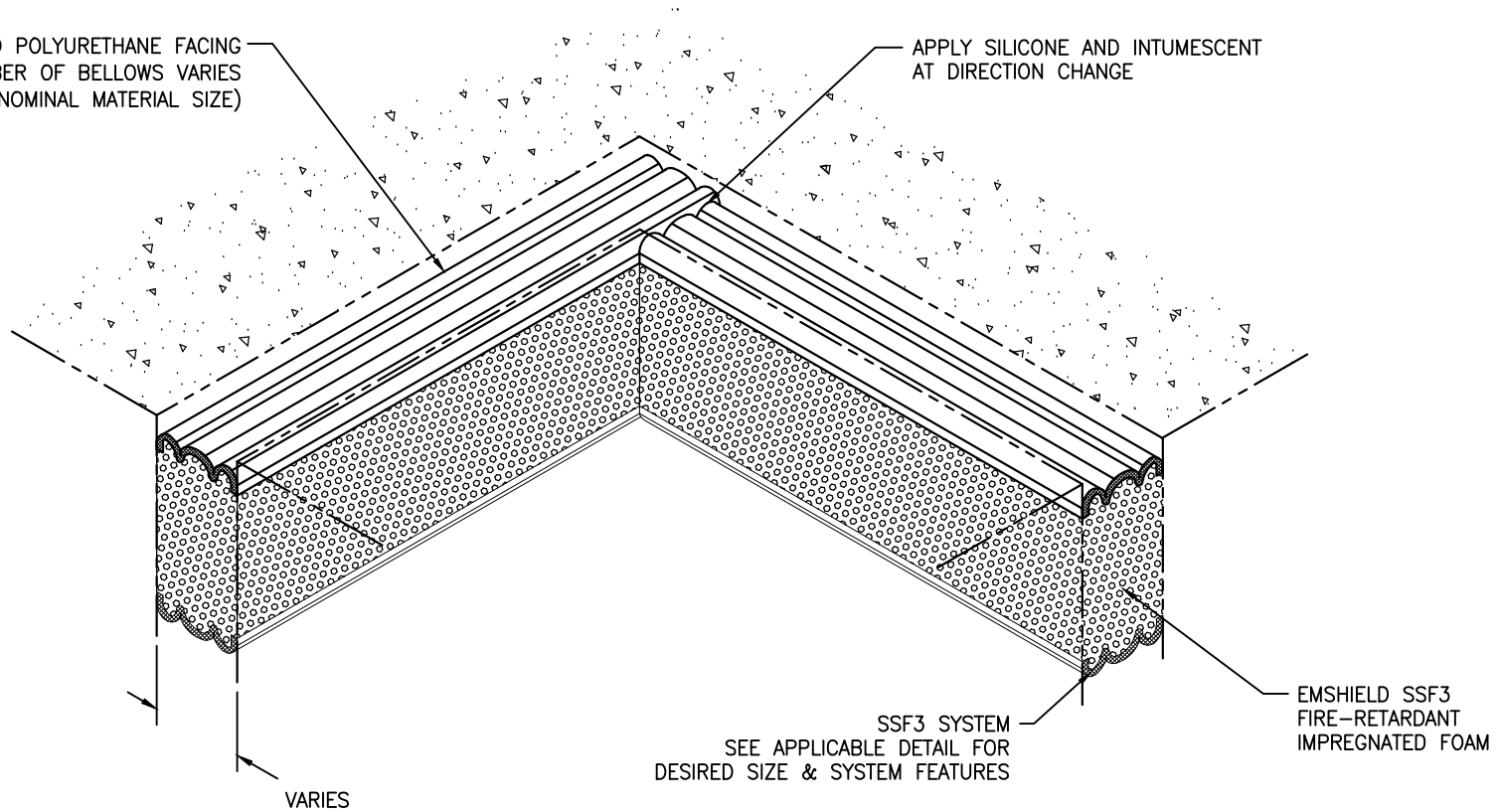

SSF3 SYSTEM
SEE APPLICABLE DETAIL FOR
DESIRED SIZE & SYSTEM FEATURES

EMsheild SSF3
FIRE-RETARDANT
IMPREGNATED FOAM

VARIES

MOVEMENT: ± 50 (TOTAL 100%) OF NOMINAL MATERIAL SIZE

EMSEAL JOINT SYSTEMS LTD.

EMSHEILD SSF3- HORIZONTAL TRANSITION - TYPICAL

THIS DOCUMENT CONTAINS INFORMATION OF A CONFIDENTIAL NATURE AND IS PROPRIETARY TO EMSEAL JOINT SYSTEMS LTD. ANY UNAUTHORIZED USE WILL BE PROSECUTED. THIS DRAWING IS PROTECTED BY COPYRIGHT, THE RIGHT TO REPRODUCE IN ANY FORM BEING THE EXCLUSIVE RIGHT OF EMSEAL JOINT SYSTEMS LTD. ANY UNAUTHORIZED REPRODUCTION WHETHER IN TWO OR THREE DIMENSIONS WILL BE PROSECUTED. © 2014 EMSEAL JOINT SYSTEMS LTD.

DRAWN BY:	DATE:	SCALE:	SHEET
ORK	2016/19/07	N.T.S.	No: 1 OF 1
PART NUMBER:			
SSF3_HORIZONTAL_TRANSITION_TYPICAL			