

FIELD APPLIED MIN. 3/4-INCH (19.1mm)  
DEEP INJECTED SEALANT BAND AND CORNER BEAD  
ALONG SIDE OF DFR2-FP AS SHOWN - BOTH SIDES  
(SILICONE SUPPLIED BY EMSEAL)

APP. 3/4 IN  
[19.1mm]

FOR SIDE SHEET TERMINATION  
SEE DETAIL "A-A"

DFR2-FP SYSTEM  
SEE APPLICABLE DETAIL FOR  
DESIRED SIZE & SYSTEM FEATURES

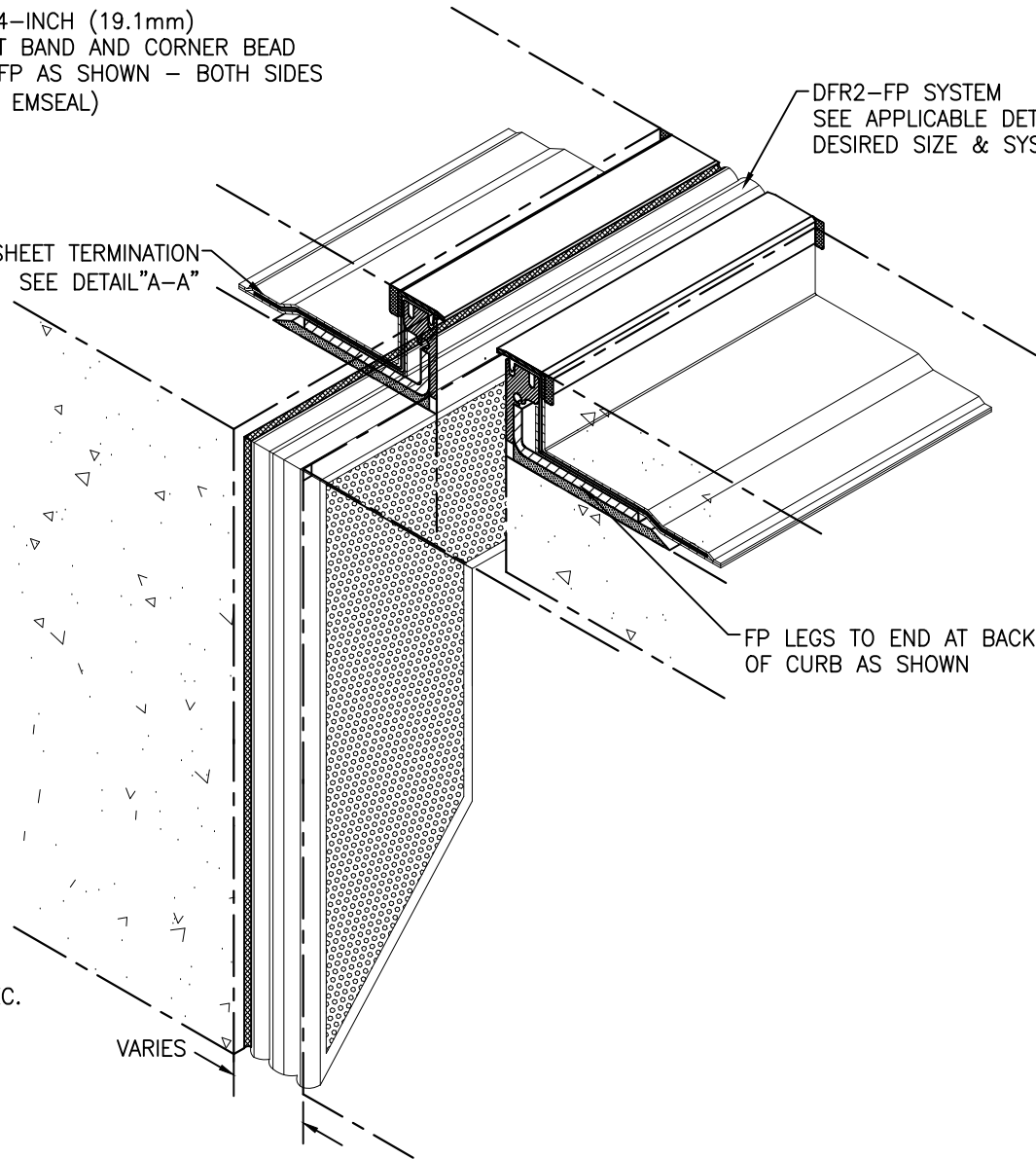

FP LEGS TO END AT BACK  
OF CURB AS SHOWN

VARIES

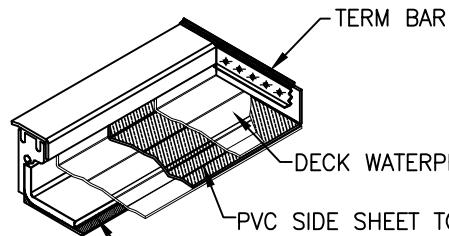

TERM BAR

DECK WATERPROOFING

PVC SIDE SHEET TO BE ENCAPSULATED  
IN DECK WATERPROOFING ACCORDING  
TO WATERPROOFING MANUFACTURERS REC.

DETAIL "A-A"

EPOXY ADHESIVE SETTING BED

MOVEMENT:  $\pm 50\%$  (TOTAL 100%) OF NOMINAL MATERIAL SIZE

# EMSEAL JOINT SYSTEMS LTD.

## DFR2-FP\_U-90 DOWNTURN TRANSITION WITH FP LEG TERMINATION

THIS DOCUMENT CONTAINS INFORMATION OF A CONFIDENTIAL NATURE AND IS PROPRIETARY TO EMSEAL JOINT SYSTEMS LTD. ANY UNAUTHORIZED USE WILL BE PROSECUTED. THIS DRAWING IS PROTECTED BY COPYRIGHT, THE RIGHT TO REPRODUCE IN ANY FORM BEING THE EXCLUSIVE RIGHT OF EMSEAL JOINT SYSTEMS LTD. ANY UNAUTHORIZED REPRODUCTION WHETHER IN TWO OR THREE DIMENSIONS WILL BE PROSECUTED. © 2014 EMSEAL JOINT SYSTEMS LTD.

DRAWN BY: ORK	DATE: 2016/09/23	SCALE: N.T.S.	SHEET No: 1 OF 1
------------------	---------------------	------------------	---------------------

PART NUMBER:  
DFR2\_FP\_U-90-DOWNTURN\_WITH\_45\_DEG\_TERM