

30 ANCHORS TOTAL PER  
13.12 LF (4m) LENGTH  
(15 ANCHORS EACH SIDE)

4.41 IN  
(112mm)

ELASTOMERIC SEAL – AVAILABLE  
IN BLACK, GREY, BEIGE, & BROWN  
MIGUA FN 35/15

$\approx .08$   
(2mm)

$\approx .59$   
(15mm)

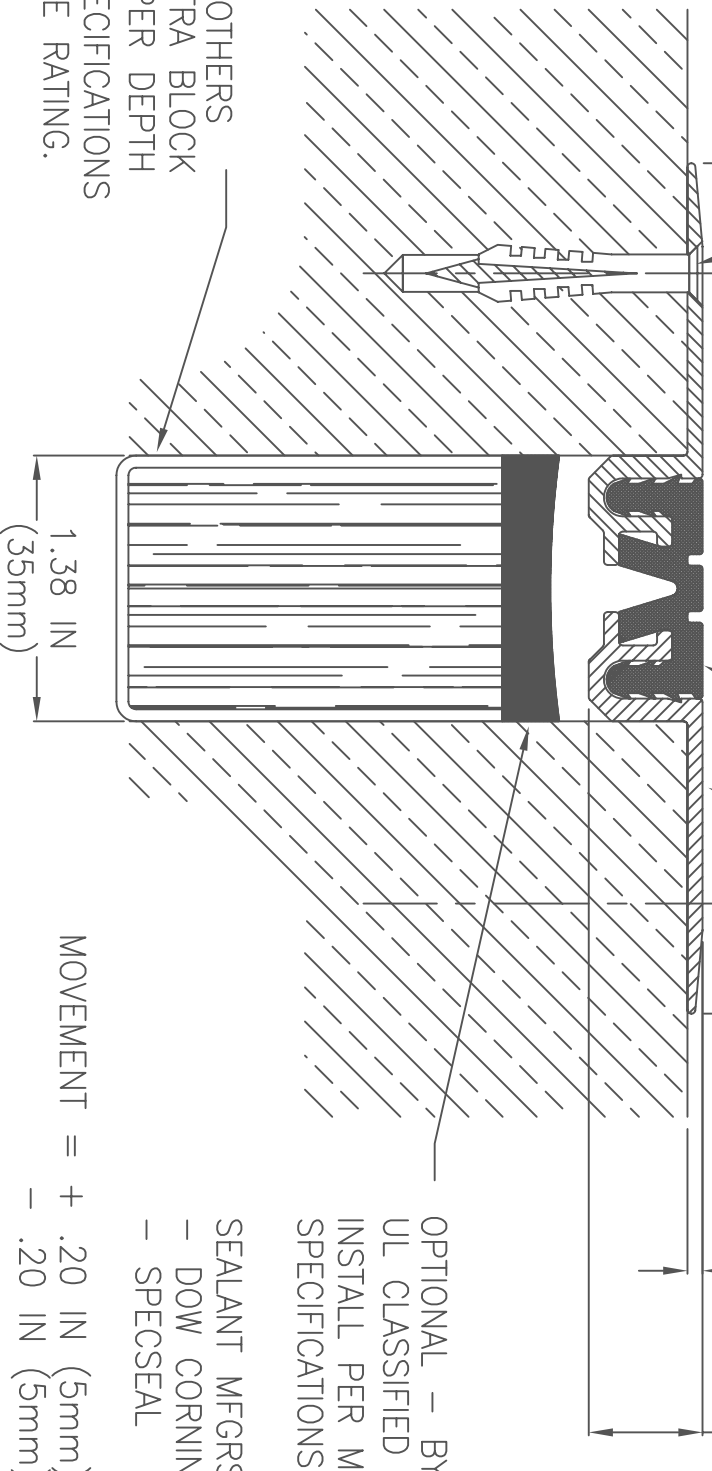

OPTIONAL – BY OTHERS  
MULTI-LAYER ULTRA BLOCK  
INSTALL TO PROPER DEPTH  
PER MFG'R'S. SPECIFICATIONS  
FOR PROPER FIRE RATING.

OPTIONAL – BY OTHERS  
UL CLASSIFIED SEALANT  
INSTALL PER MFG'RS.  
SPECIFICATIONS

SEALANT MFGRS:  
– DOW CORNING  
– SPECSEAL  
MOVEMENT = + .20 IN (5mm)  
– .20 IN (5mm)

CD-ROM VERSION 3 FILENAME: FN3515SurfaceMounted

# EMSEAL JOINT SYSTEMS LTD.

MIGUA FN 35/15 INTERIOR JOINT

C:\DETAILS\MIGUA\FN\35\

THIS DOCUMENT CONTAINS INFORMATION OF A CONFIDENTIAL NATURE UNAVAILABLE TO THE PUBLIC AND IS PROPRIETARY TO EMSEAL CORPORATION. ANY UNAUTHORIZED USE, REPRODUCTION, OR REPERIODIC REPRODUCTION IN ANY FORM OR BY ANY MEANS WITHOUT THE WRITTEN PERMISSION OF EMSEAL CORPORATION IS STRICTLY PROHIBITED. ANY UNAUTHORIZED REPRODUCTION OF THIS DOCUMENT IN ANY FORM OR BY ANY MEANS WITHOUT THE WRITTEN PERMISSION OF EMSEAL CORPORATION WILL BE PROSECUTED.

DRAWN BY: WAJ	DATE: 2/26/98	SCALE: N.T.S.	SHEET NO:
PART NUMBER: 001-0-00-00			