

FIELD-APPLIED SILICONE SEALANT BAND AND CORNER BEADS FORCED DOWN ALONG SIDE OF EMSHIELD DFR2 AS SHOWN - BOTH SIDES (SILICONE SUPPLIED BY EMSEAL)

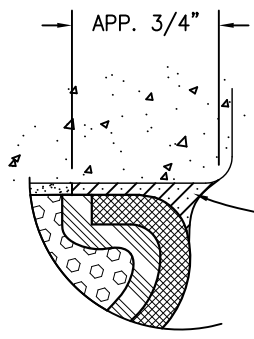

FACTORY-APPLIED AND CURED TRAFFIC-GRADE SILICONE FACING (PECORA 301)

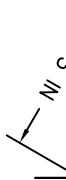

FACTORY-APPLIED AND CURED INTUMESCENT FACING

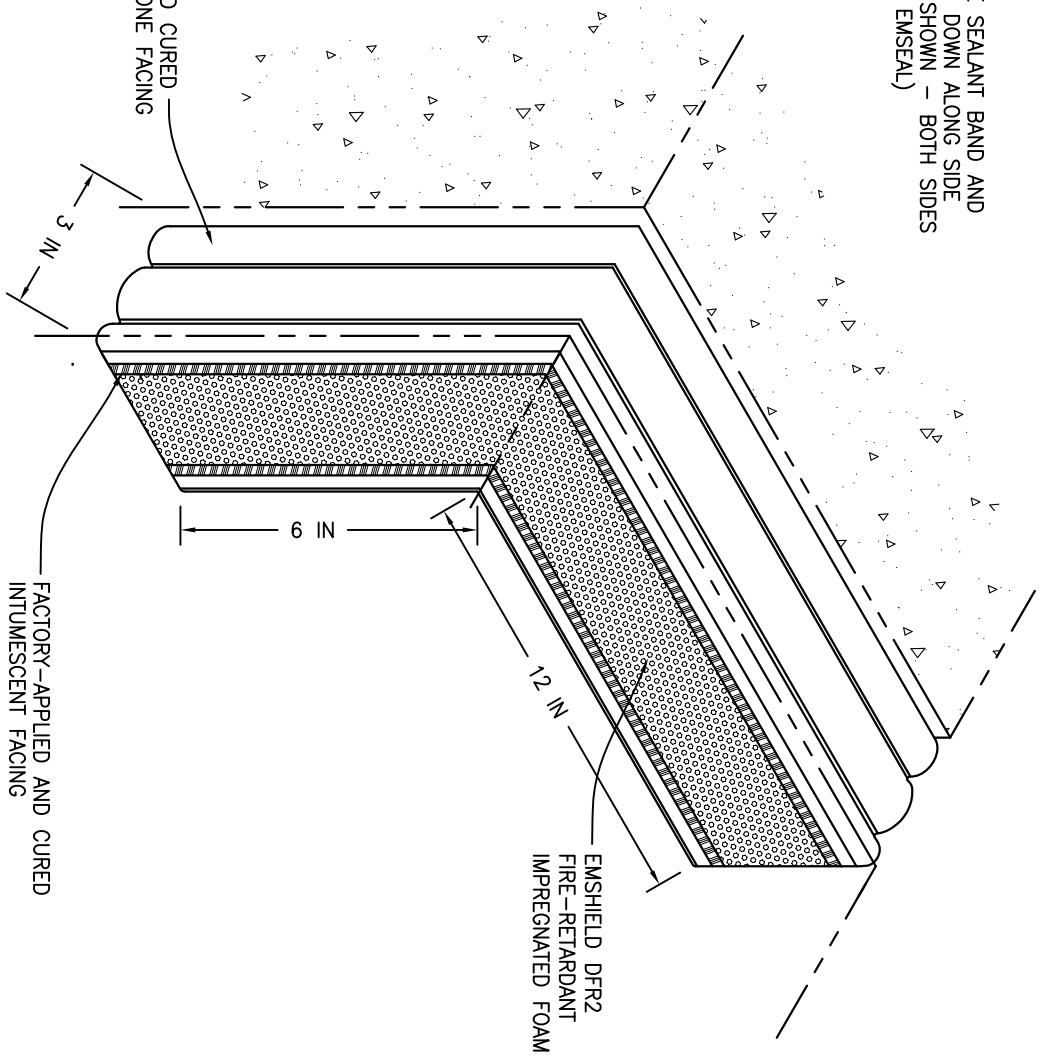

JOINT GAPS FROM 1 TO 4 INCHES (25-100mm)
MOVEMENT: ±25% (TOTAL 50%) OF NOMINAL MATERIAL SIZE

EMSEAL'S EMSHIELD DFR2 HAS BEEN TESTED IN ACCORDANCE WITH UL 2079 IN THE CONFIGURATION DEPICTED IN UL SYSTEM # FT-D-1086. USE OF THIS MATERIAL IN DECK ASSEMBLY CONFIGURATIONS OTHER THAN DEPICTED IN UL SYSTEM # FT-D-1086 WILL NOT ENCUMBER OR LOWER THE RESISTANCE OF THE DECK BUT IS DONE SO AT THE DESIGNERS' DISCRETION AND RESPONSIBILITY FOR DESIGN OF A FIRE RATED DECK ASSEMBLY THAT MEETS APPLICABLE STANDARDS FOR THE PROJECT.

EMSEAL JOINT SYSTEMS LTD.

EMSHEILD DFR2 OUTSIDE VERTICAL PLANE UNIVERSAL - 90

THIS DOCUMENT CONTAINS INFORMATION OF A CONFIDENTIAL NATURE UNLESS INDICATED OTHERWISE. IT IS THE PROPERTY OF EMSEAL CORPORATION AND IS LOANED TO YOU FOR YOUR USE ONLY. IT IS NOT TO BE REPRODUCED OR TRANSMITTED IN ANY FORM OR BY ANY MEANS, ELECTRONIC OR MECHANICAL, INCLUDING PHOTOCOPYING, RECORDING, OR BY ANY INFORMATION STORAGE AND RETRIEVAL SYSTEM, WITHOUT THE WRITTEN PERMISSION OF EMSEAL CORPORATION. ANY UNAUTHORIZED REPRODUCTION OR TRANSMISSION OF THIS DOCUMENT IS PROHIBITED.

DRAWN BY:	DATE:	SCALE:	SHEET
TAB	11/21/09	N.T.S.	No: 1 OF 1
PART NUMBER:	FOAM\EMSHIELD\DFR2\EMSHEILD DFR2 OUTSIDE VERTICAL U-90 - 001		

A	07/13/09	TAB	GENERAL REVISIONS
---	----------	-----	-------------------