

FIELD-APPLIED SILICONE SEALANT BAND AND CORNER BEADS FORCED DOWN ALONG SIDE OF EMSHIELD DFR2 AS SHOWN - BOTH SIDES (SILICONE SUPPLIED BY EMSSEAL)

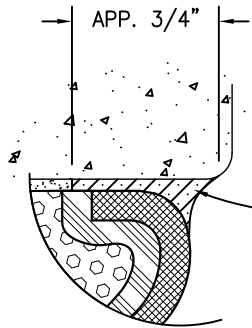

JOINT GAPS FROM 1 TO 4 INCHES (25-100mm)
MOVEMENT: ±25% (TOTAL 50%) OF NOMINAL MATERIAL SIZE

FACTORY-APPLIED AND CURED TRAFFIC-GRADE SILICONE FACING (PECORA 301)

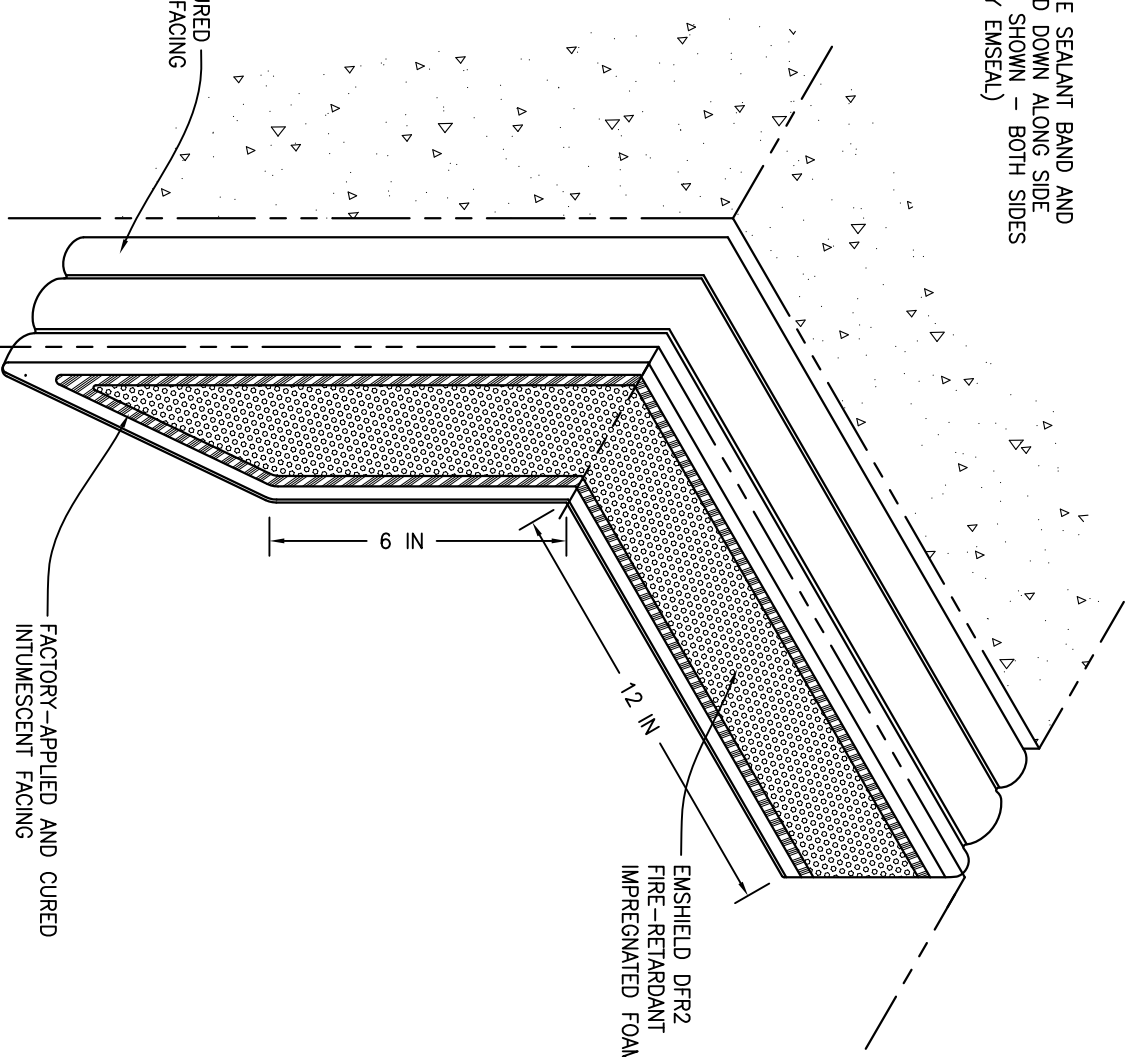

FACTORY-APPLIED AND CURED INTUMESCENT FACING

EMSHIELD DFR2 FIRE-RETARDANT IMPREGNATED FOAM

EMSEAL'S EMSHIELD DFR2 HAS BEEN TESTED IN ACCORDANCE WITH UL 2079 IN THE CONFIGURATION DEPICTED IN UL SYSTEM # FT-D-1086. USE OF THIS MATERIAL IN DECK ASSEMBLY CONFIGURATIONS OTHER THAN DEPICTED IN UL SYSTEM # FT-D-1086 WILL NOT ENCUMBER OR LOWER THE RESISTANCE OF THE DECK BUT IS DONE SO AT THE DESIGNERS' DISCRETION AND RESPONSIBILITY FOR DESIGN OF A FIRE RATED DECK ASSEMBLY THAT MEETS APPLICABLE STANDARDS FOR THE PROJECT.

EMSEAL JOINT SYSTEMS LTD.

VERTICAL PLANE UNIVERSAL-90 W/45° TERMINATION

THIS DOCUMENT CONTAINS INFORMATION OF A CONFIDENTIAL NATURE UNLESS INDICATED OTHERWISE. IT IS THE PROPERTY OF EMSEAL CORPORATION. ANY UNAUTHORIZED USE WILL BE PROSECUTED. THIS DRAWING IS PROTECTED BY COPYRIGHT. THE RIGHT TO REPRODUCE IN ANY FORM BEING THE EXCLUSIVE RIGHT OF EMSEAL CORPORATION. ANY UNAUTHORIZED REPRODUCTION WHETHER IN TWO OR THREE DIMENSIONS WILL BE PROSECUTED.

DRAWN BY:	DATE:	SCALE:	SHEET
	TAB	11/15/09	N.T.S.
PART NUMBER:	DATE:	SCALE:	SHEET
	FOAM	11/15/09	N.T.S.
EMSHIELD DFR2 OUTSIDE 45 DEG TERMINATION U-90 - 001			
DRAWN BY: TAB			
DATE: 11/15/09			
SCALE: N.T.S.			
SHEET No: 1 OF 1			
PART NUMBER: FOAM			
EMSHIELD DFR2 OUTSIDE 45 DEG TERMINATION U-90 - 001			
DRAWN BY: TAB			
DATE: 07/13/09			
SCALE: N.T.S.			
SHEET No: 1 OF 1			
PART NUMBER: GENERAL REVISIONS			
EMSEAL'S EMSHIELD DFR2 HAS BEEN TESTED IN ACCORDANCE WITH UL 2079 IN THE CONFIGURATION DEPICTED IN UL SYSTEM # FT-D-1086. USE OF THIS MATERIAL IN DECK ASSEMBLY CONFIGURATIONS OTHER THAN DEPICTED IN UL SYSTEM # FT-D-1086 WILL NOT ENCUMBER OR LOWER THE RESISTANCE OF THE DECK BUT IS DONE SO AT THE DESIGNERS' DISCRETION AND RESPONSIBILITY FOR DESIGN OF A FIRE RATED DECK ASSEMBLY THAT MEETS APPLICABLE STANDARDS FOR THE PROJECT.			
JOINT GAPS FROM 1 TO 4 INCHES (25-100mm)			
MOVEMENT: ±25% (TOTAL 50%) OF NOMINAL MATERIAL SIZE			
FACTORY-APPLIED AND CURED TRAFFIC-GRADE SILICONE FACING (PECORA 301)			
FACTORY-APPLIED AND CURED INTUMESCENT FACING			
EMSHIELD DFR2 FIRE-RETARDANT IMPREGNATED FOAM			
EMSEAL JOINT SYSTEMS LTD.			
VERTICAL PLANE UNIVERSAL-90 W/45° TERMINATION			
THIS DOCUMENT CONTAINS INFORMATION OF A CONFIDENTIAL NATURE UNLESS INDICATED OTHERWISE. IT IS THE PROPERTY OF EMSEAL CORPORATION. ANY UNAUTHORIZED USE WILL BE PROSECUTED. THIS DRAWING IS PROTECTED BY COPYRIGHT. THE RIGHT TO REPRODUCE IN ANY FORM BEING THE EXCLUSIVE RIGHT OF EMSEAL CORPORATION. ANY UNAUTHORIZED REPRODUCTION WHETHER IN TWO OR THREE DIMENSIONS WILL BE PROSECUTED.			
DRAWN BY: TAB			
DATE: 07/13/09			
SCALE: N.T.S.			
SHEET No: 1 OF 1			
PART NUMBER: GENERAL REVISIONS			
EMSEAL'S EMSHIELD DFR2 HAS BEEN TESTED IN ACCORDANCE WITH UL 2079 IN THE CONFIGURATION DEPICTED IN UL SYSTEM # FT-D-1086. USE OF THIS MATERIAL IN DECK ASSEMBLY CONFIGURATIONS OTHER THAN DEPICTED IN UL SYSTEM # FT-D-1086 WILL NOT ENCUMBER OR LOWER THE RESISTANCE OF THE DECK BUT IS DONE SO AT THE DESIGNERS' DISCRETION AND RESPONSIBILITY FOR DESIGN OF A FIRE RATED DECK ASSEMBLY THAT MEETS APPLICABLE STANDARDS FOR THE PROJECT.			
JOINT GAPS FROM 1 TO 4 INCHES (25-100mm)			
MOVEMENT: ±25% (TOTAL 50%) OF NOMINAL MATERIAL SIZE			
FACTORY-APPLIED AND CURED TRAFFIC-GRADE SILICONE FACING (PECORA 301)			
FACTORY-APPLIED AND CURED INTUMESCENT FACING			
EMSHIELD DFR2 FIRE-RETARDANT IMPREGNATED FOAM			
EMSEAL JOINT SYSTEMS LTD.			
VERTICAL PLANE UNIVERSAL-90 W/45° TERMINATION			
THIS DOCUMENT CONTAINS INFORMATION OF A CONFIDENTIAL NATURE UNLESS INDICATED OTHERWISE. IT IS THE PROPERTY OF EMSEAL CORPORATION. ANY UNAUTHORIZED USE WILL BE PROSECUTED. THIS DRAWING IS PROTECTED BY COPYRIGHT. THE RIGHT TO REPRODUCE IN ANY FORM BEING THE EXCLUSIVE RIGHT OF EMSEAL CORPORATION. ANY UNAUTHORIZED REPRODUCTION WHETHER IN TWO OR THREE DIMENSIONS WILL BE PROSECUTED.			